

---

---

# **Malleable Pipe Fittings, and Unions, Cast Iron Pipe Fittings and Wardlox and Teelox**

---

---

---

## **Price Schedule**

No. 300511

Effective May 23, 2011

---



**WARD MANUFACTURING**

Blossburg, Pennsylvania 16912 • 570-638-2131 • Fax: 570-241-0100 • [www.wardfittings.com](http://www.wardfittings.com)

---

## TERMS & CONDITIONS OF SALE

**1. PRICES:** This price sheet supersedes all previous issues. Prices in price sheets are subject to change without notice. Prices apply only to standard sizes as listed in catalog.

**2. APPROVAL & ACCEPTANCE OF ORDERS:**  
All orders are accepted on the basis of prices in effect at the time of shipment.

**3. TAXES:** Any Manufacturer or Sales Tax payable on the transaction under any effective statute will be added to the prices and terms quoted, unless a valid exemption certificate is on file.

**4. CREDIT TERMS:** Two percent cash discount tenth prox., - Net 30 days.

**5. DELIVERY & SHIPMENT OF GOODS:** All goods are shipped at buyer's risk. Shipments should be carefully examined upon delivery and before the carrier's delivery receipt is signed. If any loss or damage is evident, the buyer should make an appropriate notation on the delivery receipt and insist that the carrier's driver initial such exception. The contents of all packages should be carefully examined for concealed damage as soon as possible after delivery, so that the carrier can be requested, within 48 hours after delivery, to arrange for prompt inspection of the damaged goods.

Completion of all orders accepted and fulfillment of all agreements or contracts entered into are subject to any delay which might be occasioned by labor disputes, fires, accidents, embargoes, trade restrictions, governmental directives or other causes beyond our control.

All promises of shipment will be as closely estimated as possible. We use our efforts in every case to ship within the time promised, but cannot guarantee to do so.

All claims for shortage must be made on receipt of goods. We prove our count by weighing the package. Claims for shortage are subject to that test.

Typographical, clerical, arithmetical errors or omissions in orders, invoices, quotations, price schedules, acknowledgments, or other documents are subject to correction.

**6. RETURN OF GOODS:** No goods will be taken back and credited without prior approval and issuance of a return goods authorization (RGA) number.

All fittings returned with our permission must be goods of our manufacture, and in clean saleable condition.

Credit will only be allowed on the basis of prices agreed upon. If product returned is a result of a customer ordering error or overstocking situation, the credit will be less 20 percent to cover handling costs, less any costs of returning to a saleable condition, and less transportation charges on original and return shipments.

Orders for special goods are not subject to cancellation for any reason after work has been started on them, except upon agreement to make payment for all work which has been performed.

**7. WARRANTY:** We guarantee these products to the extent that we will replace those having manufacturing defects, under normal use and service. No charge for labor or expense required to repair defective goods, or occasioned by them, will be allowed. If the goods are defective, the measure of the damage is the price of the defective goods only.

**8. FREIGHT TERM:** Shipments of 2000 pounds or more will be prepaid in the continental U.S. (except Alaska). We reserve the right to choose shipping point and carrier.

**9. CARTON & BOX QUANTITY ADJUSTMENT:**  
On orders received for less than master carton or box quantities, we reserve the right to adjust to the next carton or box quantity above the number of pieces shown on the order. Items subject to adjustment are identified with stars in the price sheet.

**10. WEIGHTS:** The weights per piece or per 100 pieces given in the price sheet, catalogs, and quotations are not guaranteed, but are approximate and for your convenience.

**11. ILLUSTRATIONS:** Illustrations in catalogs and price sheets are actual representations of a certain size of each product line but do not necessarily represent all sizes in all details.

Materials, Designs, and Specifications in catalogs and price sheets are subject to change without notice in keeping our policy of continuing product improvement.

**12. SPECIAL CONDITIONS:** Any additional cost incurred in packaging or in making any special tests or inspection requested by Buyer in addition to those commercially supplied by Ward Manufacturing, Inc., will be charged to Buyer. Such tests and inspections will be made at the factory before date of shipment.

Orders for fittings or parts will be subject to a net minimum invoice charge of \$35.00 Net plus applicable handling and freight charges.

**13. US EXPORT COMPLIANCE:** The products sold by Ward Manufacturing, Inc. may be subject to the export control laws and regulations of the United States Government. Buyer may not make any disposition of such products, by way of sale, export, re-export, transshipment or otherwise, except as permitted under applicable U.S. law.

PIECES ORDERED		SIZE IN INCHES	PCS. PER BOX	PCS. PER MASTER CARTON	WGHT PER 100	PRICE PER PIECE	
BLACK	GALV.					BLACK	GALV.

**MALLEABLE IRON 90° ELBOWS**  
Fig. 47

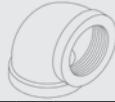

	1/8	35	210	8	★ 6.00	★ 9.29	
	1/4	30	180	12	★ 5.86	★ 8.48	
	3/8	30	180	19	★ 5.86	★ 8.48	
	1/2	50	200	26	⊕ 4.06	⊕ 5.46	
	3/4	35	140	43	⊕ 4.90	⊕ 6.71	
	1	20	80	69	⊕ 8.51	⊕ 12.42	
	1-1/4	20	40	102	⊕ 14.03	★ 19.63	
	1-1/2	8	32	135	⊕ 18.46	★ 25.62	
	2	8	16	201	⊕ 31.82	★ 41.98	
	2-1/2	12	12	449	★ 70.88	★ 109.85	
	3	5	5	710	★ 103.72	★ 181.11	
	3-1/2	NEW	3	6	665	POA	POA
	4	NEW	4	4	919	222.79	319.43
	5	NEW	1	1	1,355	POA	POA
	6		1	1	2,255	752.03	1271.76
	1/4 x 1/8	30	180	10	★ 11.66	15.23	
	3/8 x 1/8	NEW	25	75	15	POA	POA
	3/8 x 1/4	25	150	16	★ 8.24	13.58	
	1/2 x 3/8	50	200	24	★ 7.74	★ 10.05	
	1/2 x 1/4	30	180	22	★ 7.95	★ 11.76	
	3/4 x 1/4	NEW	12	24	28	POA	POA
	3/4 x 1/2	30	120	35	★ 7.95	★ 11.66	
	3/4 x 3/8	30	180	30	★ 11.11	16.09	
	1 x 3/4	20	80	56	★ 10.23	★ 14.97	
	1 x 1/2	25	100	50	★ 11.03	★ 15.89	
	1 x 3/8	25	100	47	★ 21.70	28.2	
	1-1/4 x 1	10	40	83	★ 17.18	★ 25.1	
	1-1/4 x 3/4	15	60	74	★ 19.16	★ 30.16	
	1-1/4 x 1/2	15	60	65	★ 22.39	31.96	
	1-1/2 x 1-1/4	15	30	120	★ 24.24	★ 40.12	
	1-1/2 x 1	10	40	106	★ 24.24	★ 40.12	
	1-1/2 x 3/4	12	48	89	★ 27.73	★ 40.12	
	1-1/2 x 1/2	12	48	79	★ 26.57	★ 34.66	
	2 x 1-1/2	10	20	172	★ 35.10	★ 46.88	
	2 x 1-1/4	10	20	154	★ 39.90	★ 53.74	
	2 x 1	12	24	134	★ 39.90	★ 55.75	
	2 x 3/4	15	30	140	★ 42.30	★ 56.88	
	2 x 1/2	10	40	121	★ 33.53	★ 44.87	
	2-1/2 x 2	12	12	312	96.35	158.89	
	2-1/2 x 1-1/2	12	12	256	102.02	177.02	
	3 x 2	8	8	382	155.76	250.82	
	3 x 2-1/2	NEW	4	8	423	POA	POA
	4 x 3	NEW	4	4	738	POA	POA

**MALLEABLE IRON 45° ELBOWS**  
Fig. 48



	1/8	35	210	8	★ 8.83	13.67
	1/4	35	210	13	★ 8.83	★ 11.57
	3/8	40	240	17	★ 8.83	★ 12.92
	1/2	50	200	26	★ 6.70	★ 8.64
	3/4	40	160	38	★ 8.29	★ 12.42
	1	25	100	56	★ 10.44	★ 14.03
	1-1/4	10	40	90	★ 18.47	★ 26.21
	1-1/2	10	40	122	★ 22.84	★ 30.78

PIECES ORDERED		SIZE IN INCHES	PCS. PER BOX	PCS. PER MASTER CARTON	WGHT PER 100	PRICE PER PIECE	
BLACK	GALV.					BLACK	GALV.

**MALLEABLE IRON 45° ELBOWS**  
(continued) Fig. 48



	2	8	16	187	★ 34.54	★ 45.55	
	2-1/2	15	15	320	99.95	158.5	
	3	8	8	451	129.83	230.53	
	4	4	4	719	254.58	386.45	
	5	NEW	1	1	1,120	POA	POA
	6	NEW	1	1	1,910	POA	POA

**MALLEABLE IRON 90° STREET ELLS** Fig. 50



	1/8	40	240	7	★ 8.65	★ 12.14	
	1/4	30	180	11	★ 8.65	★ 11.75	
	3/8	30	180	18	★ 8.65	★ 11.75	
	1/2	50	200	27	⊕ 8.40	★ 12.01	
	3/4	35	140	43	⊕ 8.40	★ 12.01	
	1	20	80	60	⊕ 11.89	★ 16.06	
	1-1/4	15	30	106	★ 18.47	★ 26.96	
	1-1/2	12	24	143	★ 24.71	★ 33.84	
	2	8	16	236	★ 40.15	★ 57.06	
	2-1/2	8	8	358	101.77	165.05	
	3	8	8	705	155.35	240.2	
	4	NEW	1	1	1,065	POA	POA
	1/2 x 3/8	35	280	22	12.42	19.46	
	3/4 x 1/2	25	100	36	18.54	25.24	
	1 x 3/4	NEW	25	100	53	POA	POA
	1-1/4 x 3/4	NEW	15	60	75	POA	POA
	1-1/4 x 1	NEW	15	30	101	POA	POA
	1-1/2 x 1	NEW	20	40	185	POA	POA
	1-1/2 x 1-1/4	16	32	140	★ 44.87	55.08	
	2 x 1-1/2	12	24	19	POA	POA	

**MALLEABLE IRON 45° STREET ELLS** Fig. 51



	1/8	30	180	7	★ 13.60	★ 17.68
	1/4	25	150	10	★ 11.31	★ 16.33
	3/8	30	180	15	★ 11.48	★ 17.42
	1/2	50	200	21	★ 9.37	★ 13.2
	3/4	40	160	32	★ 14.15	★ 20.95
	1	25	100	55	★ 16.48	★ 26.84
	1-1/4	25	50	86	★ 28.49	★ 40.28
	1-1/2	15	30	109	★ 36.74	★ 48.78
	2	10	20	170	★ 61.77	★ 80.34

**MALLEABLE IRON TEES**  
Fig. 52



	1/8	35	210	13	★ 9.04	★ 13.14	
	1/8 x 1/4	NEW	25	50	12	POA	POA
	1/4	35	210	17	★ 8.51	★ 11.08	
	1/4 x 1/8	NEW	25	50	13	POA	POA
	1/4 x 1/4 x 3/8	NEW	15	30	19	POA	POA
	3/8	30	180	26	★ 8.51	★ 11.08	
	3/8 x 3/8 x 1/4	NEW	15	30	21	POA	POA
	3/8 x 1/4 x 1/4	NEW	15	30	19	POA	POA
	3/8 x 1/4 x 3/8	NEW	15	30	17	POA	POA
	1/2	30	120	37	⊕ 5.42	⊕ 7.08	

⊕ Preceding List Price Indicates Available In Master Quantity From Blossburg Factory ★ Preceding List Price Indicates Available In Box Quantity Only From Blossburg Factory

PIECES ORDERED	SIZE IN INCHES	PCS. PER BOX	PCS. PER MASTER CARTON	WGHT PER 100	PRICE PER PIECE	
					BLACK	GALV.

PIECES ORDERED	SIZE IN INCHES	PCS. PER BOX	PCS. PER MASTER CARTON	WGHT PER 100	PRICE PER PIECE	
					BLACK	GALV.

## MALLEABLE IRON TEES (continued) Fig. 52



	3/4		20	80	60	7.78	11.66
	3/4 x 3/8 x 3/8	NEW	35	140	36	POA	POA
	3/4 x 3/4 x 1-1/4	NEW	10	40	88	POA	POA
	1		12	48	91	13.33	18.86
	1-1/4		15	30	138	21.60	29.93
	1-1/2		10	20	184	26.85	37.21
	2		15	15	312	45.78	60.47
	2-1/2		8	8	494	98.70	170.27
	3		6	6	722	145.39	199.68
	4		3	3	1,215	351.40	472.35
	3/8 x 3/8 x 1/4		15	30	21	13.39	19.33
	1/2 x 1/2 x 3/8		35	140	36	11.86	16.44
	1/2 x 1/2 x 1/4		25	100	29	9.24	13.58
	1/2 x 3/8 x 1/2		35	140	36	14.44	21.39
	1/2 x 3/8 x 3/8		35	140	32	14.44	19.31
	1/2 x 1/4 x 1/2		35	140	32	9.70	16.1
	3/8 x 3/8 x 1/2		30	180	34	12.63	16.76
	3/4 x 3/4 x 1/2		25	100	52	12.05	16.23
	3/4 x 3/4 x 3/8		30	120	49	14.79	17.44
	3/4 x 3/4 x 1/4		30	120	43	13.39	17.33
	3/4 x 1/2 x 3/4		20	80	54	13.91	18.51
	3/4 x 1/2 x 1/2		30	120	45	12.37	19.4
	3/4 x 3/8 x 3/4		25	100	53	37.20	POA
	3/4 x 1/4 x 3/4		30	120	46	18.47	25.3
	3/4 x 3/4 x 1		15	60	73	18.34	27.92
	1/2 x 1/2 x 3/4		30	120	46	13.91	19.4
	1/2 x 1/2 x 1		25	100	55	22.74	32.58
	1 x 1 x 3/4		25	50	79	15.20	22.78
	1 x 1 x 1/2		15	60	71	15.20	22.78
	1 x 1 x 3/8		20	80	66	21.38	29.06
	1 x 1 x 1/4		20	80	63	19.25	31.69
	1 x 1 x 1-1/4		15	30	123	33.66	46.04
	1 x 1 x 1-1/2		8	16	113	55.16	85.68
	1 x 3/4 x 1		20	40	82	17.65	28.45
	1 x 3/4 x 3/4		20	40	71	16.09	27.44
	1 x 3/4 x 1/2		20	40	68	17.41	28.45
	1 x 1/2 x 1		15	60	76	17.32	28.45
	1 x 1/2 x 3/4		20	80	65	20.66	29.06
	1 x 1/2 x 1/2		20	80	54	17.32	28.45
	1 x 1/4 x 1		15	60	70	17.65	29.48
	1 x 1 x 2	NEW	12	24	170	POA	POA
	1-1/4 x 3/4 x 1-1/4		15	30	125	29.24	42.00
	1-1/4 x 3/4 x 1		10	40	119	29.88	46.31
	1-1/4 x 3/4 x 3/4		10	40	98	32.27	48.72
	1-1/4 x 1/2 x 1	NEW	10	40	94	POA	POA
	1-1/4 x 1/2 x 1-1/4		10	40	119	32.27	44.77
	1-1/4 x 1-1/4 x 3/8	NEW	10	40	85	POA	POA
	1-1/4 x 1-1/4 x 1		14	28	116	26.33	35.33
	1-1/4 x 1-1/4 x 3/4		12	24	109	24.29	35.33
	1-1/4 x 1-1/4 x 1/2		15	30	99	27.71	37.34
	1-1/4 x 1 x 1-1/4		15	30	123	34.07	45.33
	1-1/4 x 1 x 1		15	30	109	28.38	42.87
	1-1/4 x 1 x 3/4		15	30	98	28.38	44.77
	1-1/4 x 1 x 1/2		15	60	86	35.13	47.57
	1-1/4 x 1-1/4 x 1-1/2		10	20	153	42.44	62.92
	1-1/4 x 2	NEW	12	24	183	POA	POA
	1-1/2 x 3/4 x 1-1/2		10	20	153	38.56	56.14
	1-1/2 x 3/4 x 3/4		10	40	108	64.63	81.94
	1-1/2 x 1/2 x 1-1/2		10	20	154	38.56	61.56

## MALLEABLE IRON TEES (continued) Fig. 52



	1-1/2 x 1 x 1-1/4	NEW	15	30	142	POA	POA
	1-1/2 x 1-1/2 x 1-1/4		8	16	175	37.92	54.64
	1-1/2 x 1-1/2 x 1		10	20	149	30.66	43.64
	1-1/2 x 1-1/2 x 3/4		10	20	132	30.66	43.64
	1-1/2 x 1-1/2 x 1/2		8	32	121	32.46	46.12
	1-1/2 x 1-1/4 x 1-1/2		10	20	180	58.14	77.82
	1-1/2 x 1-1/4 x 1-1/4		10	20	163	51.73	77.82
	1-1/2 x 1-1/4 x 1		8	16	151	33.10	53.06
	1-1/2 x 1-1/4 x 3/4		10	20	135	38.56	56.14
	1-1/2 x 1-1/4 x 1/2		10	20	111	42.44	64.76
	1-1/2 x 1 x 1-1/2		10	20	165	38.56	56.14
	1-1/2 x 1 x 1		10	20	135	38.56	56.14
	1-1/2 x 1-1/2 x 2	NEW	12	24	218	POA	POA
	2 x 2 x 1-1/2		8	16	247	51.73	75.02
	2 x 2 x 1-1/4		8	16	229	51.73	75.02
	2 x 2 x 1		10	20	198	48.05	62.53
	2 x 2 x 3/4		10	20	181	48.05	63.72
	2 x 2 x 1/2		10	20	172	48.97	70.99
	2 x 1-1/2 x 2		6	12	259	65.06	79.37
	2 x 1-1/2 x 1-1/2		8	16	235	59.08	77.86
	2 x 1-1/2 x 1-1/4		8	16	208	60.23	79.37
	2 x 1-1/2 x 1		8	16	194	59.08	74.95
	2 x 1-1/4 x 2		8	16	267	64.58	91.66
	2 x 1-1/4 x 1-1/4		8	16	197	60.12	79.37
	2 x 1-1/4 x 1-1/2	NEW	10	20	195	POA	POA
	2 x 1 x 2		8	16	245	60.12	79.37
	2 x 1 x 1		8	16	176	68.42	78.01
	2 x 3/4 x 2		8	16	229	59.08	77.86
	2 x 1/2 x 2		8	16	230	60.12	79.37
	2 x 2 x 2-1/2	NEW	6	12	340	POA	POA
	2-1/2 x 1-1/2 x 2	NEW	6	12	343	POA	POA
	2-1/2 x 1-1/2 x 2-1/2	NEW	6	12	390	POA	POA
	2-1/2 x 2 x 2	NEW	6	12	305	POA	POA
	2-1/2 x 2 x 2-1/2	NEW	4	8	410	POA	POA
	2-1/2 x 2-1/2 x 2		12	12	410	128.40	210.91
	2-1/2 x 2-1/2 x 1-1/2		6	12	368	149.72	234.84
	2-1/2 x 2-1/2 x 1-1/4		6	12	340	149.72	233.47
	2-1/2 x 2-1/2 x 1		6	12	321	149.72	225.05
	2-1/2 x 2-1/2 x 3/4		6	12	303	144.20	233.47
	2-1/2 x 2-1/2 x 3	NEW	4	8	582	POA	POA
	3-1/2	NEW	1	4	900	POA	POA
	3 x 2 x 3	NEW	4	8	607	POA	POA
	3 x 2-1/2 x 2	NEW	4	8	483	POA	POA
	3 x 2-1/2 x 2-1/2	NEW	4	8	575	POA	POA
	3 x 3 x 2-1/2		8	8	601	203.72	321.44
	3 x 3 x 2		8	8	573	171.49	275.98
	3 x 3 x 1-1/2		8	8	512	178.28	286.3
	3 x 3 x 1-1/4		8	8	500	181.56	291.88
	3 x 3 x 1		8	8	436	172.32	275.98
	3 x 3 x 3/4		8	8	416	174.84	385.03
	3 x 2 x 2		8	8	415	181.43	291.88
	4 x 1-1/2		1	1	720	POA	POA
	4 x 2-1/2	NEW	4	4	915	POA	POA
	4 x 4 x 3	NEW	1	1	1,075	POA	POA
	4 x 3 x 4	NEW	4	4	1,030	POA	POA
	6	NEW	1	1	2,550	POA	POA

⊛ Preceding List Price Indicates Available In Master Quantity From Blossburg Factory    ★ Preceding List Price Indicates Available In Box Quantity Only From Blossburg Factory

PIECES ORDERED		PCS. PER BOX	PCS. PER MASTER CARTON	WGHT PER 100	PRICE PER PIECE	
BLACK	GALV.				BLACK	GALV.

## MALLEABLE IRON STREET TEES Fig. 64



SIZE IN INCHES	PIECES ORDERED	PCS. PER BOX	PCS. PER MASTER CARTON	WGHT PER 100	PRICE PER PIECE BLACK	PRICE PER PIECE GALV.
1/4	NEW	25	50	15	POA	POA
1/2	NEW	15	120	35	POA	POA
3/4		20	80	58	★ 19.85	★ 25.39
3/8	NEW	12	24	25	POA	POA
1		12	24	98	★ 26.23	★ 40.14
1-1/4		10	20	162	★ 43.30	★ 66.94
1-1/4 x 1 x 1-1/4	NEW	8	16	128	63.41	95.86
1-1/2	NEW	12	24	197	67.53	102.05
2		6	12	316	124.32	195.37

## MALLEABLE IRON CROSSES Fig. 61



SIZE IN INCHES	PIECES ORDERED	PCS. PER BOX	PCS. PER MASTER CARTON	WGHT PER 100	PRICE PER PIECE BLACK	PRICE PER PIECE GALV.
1/8	NEW	25	50	13	POA	POA
1/4		15	30	18	19.75	32.34
3/8		20	160	28	20.46	33.58
1/2		30	120	45	★ 20.52	★ 29.12
3/4		15	60	73	★ 24.83	★ 35.48
1		15	30	109	★ 30.59	★ 48.96
1-1/4		12	24	188	★ 49.65	★ 73.6
1-1/2		8	16	230	★ 61.54	★ 86.1
2		8	8	336	★ 101.17	★ 163.1
2-1/2	NEW	4	8	533	POA	POA
3	NEW	4	4	735	POA	POA
4	NEW	1	1	1,290	POA	POA

## MALLEABLE IRON STRAIGHT & REDUCING PIPE COUPLINGS Fig. 53

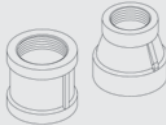

SIZE IN INCHES	PIECES ORDERED	PCS. PER BOX	PCS. PER MASTER CARTON	WGHT PER 100	PRICE PER PIECE BLACK	PRICE PER PIECE GALV.
1/8 (steel)		40	240	3	★ 7.55	★ 10.83
1/4		35	210	11	★ 7.28	★ 10.13
3/8		40	240	16	★ 7.28	★ 10.47
1/2		40	240	21	★ 5.61	★ 8.00
3/4		40	160	33	★ 6.58	★ 9.22
1		25	100	48	⊕ 9.84	★ 15.11
1-1/4		15	60	74	★ 15.10	★ 21.31
1-1/2		10	40	98	★ 17.22	★ 24.22
2		8	32	154	★ 25.52	★ 35.41
2-1/2		8	8	262	70.43	108.4
3		8	8	391	95.21	144.87
4		4	4	653	191.75	313.93
1/4 x 1/8		25	150	9	★ 7.67	★ 10.39
3/8 x 1/4		25	150	12	★ 7.67	★ 10.39
3/8 x 1/8		30	180	18	9.82	17.05
1/2 x 3/8		30	180	17	★ 6.59	★ 9.70
1/2 x 1/4		25	150	16	★ 6.97	★ 9.33
1/2 x 1/8		25	150	16	★ 7.75	12.31
3/4 x 1/2		50	200	28	⊕ 7.37	★ 10.38
3/4 x 3/8		35	210	25	★ 8.80	★ 11.78
3/4 x 1/4		35	210	23	★ 8.80	★ 11.78
3/4 x 1/8		35	210	23	★ 9.17	★ 13.51
1 x 3/4		25	100	43	★ 11.48	★ 16.06
1 x 1/2		30	120	49	★ 11.75	★ 17.29
1 x 3/8		30	120	38	★ 14.45	★ 22.46
1 x 1/4		20	160	35	15.48	24.56
1-1/4 x 1		15	60	70	★ 14.76	★ 21.93

## MALLEABLE IRON STRAIGHT & REDUCING PIPE COUPLINGS (continued) Fig. 53

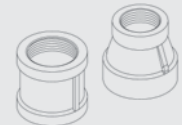

SIZE IN INCHES	PIECES ORDERED	PCS. PER BOX	PCS. PER MASTER CARTON	WGHT PER 100	PRICE PER PIECE BLACK	PRICE PER PIECE GALV.
1-1/4 x 3/4		15	60	64	★ 14.76	★ 22.37
1-1/4 x 1/2		15	60	52	★ 17.32	★ 28.7
1-1/2 x 1-1/4		10	40	96	★ 18.66	★ 27.24
1-1/2 x 1		10	40	89	★ 21.64	★ 28.84
1-1/2 x 3/4		10	40	87	★ 24.83	★ 28.84
1-1/2 x 1/2		15	60	80	★ 22.03	★ 33.84
2 x 1-1/2		10	20	146	★ 27.04	★ 36.2
2 x 1-1/4		10	20	139	★ 30.97	★ 41.59
2 x 1		15	30	127	★ 29.26	★ 39.34
2 x 3/4		8	32	138	★ 30.97	★ 43.31
2 x 1/2		8	32	141	★ 35.87	★ 48.86
2-1/2 x 2		10	10	249	62.16	109.76
2-1/2 x 1-1/2		10	10	233	73.75	116.04
2-1/2 x 1-1/4		20	20	207	79.94	149.01
2-1/2 x 1		20	20	224	79.94	126.94
3 x 2-1/2		8	8	378	93.95	140.76
3 x 2		8	8	334	80.46	137.85
3 x 1-1/2		8	8	305	97.16	145.86
3 x 1-1/4		8	8	337	100.80	154.18
3 x 1		8	8	325	98.96	154.18
3-1/2 x 2	NEW	4	8	423	POA	POA
3-1/2 x 3	NEW	4	8	475	POA	POA
4 x 1-1/2	NEW	1	1	495	POA	POA
4 x 2-1/2		4	4	571	218.42	369.44
4 x 2		4	4	524	194.75	315.6
4 x 3		4	4	621	194.75	315.6
4 x 3-1/2	NEW	4	4	620	POA	POA
5 x 4	NEW	1	1	940	POA	POA
6 x 4	NEW	1	1	1,085	POA	POA

## MALLEABLE IRON RETURN BENDS OPEN Fig. 60



SIZE IN INCHES	PIECES ORDERED	PCS. PER BOX	PCS. PER MASTER CARTON	WGHT PER 100	PRICE PER PIECE BLACK	PRICE PER PIECE GALV.
3/4		25	50	72	44.12	51.14
1		10	20	173	41.00	62.1

## MALLEABLE IRON 45 Y

SIZE IN INCHES	PIECES ORDERED	PCS. PER BOX	PCS. PER MASTER CARTON	WGHT PER 100	PRICE PER PIECE BLACK	PRICE PER PIECE GALV.
3/8	NEW	12	24	28	POA	POA
1/2	NEW	35	140	39	POA	POA
3/4	NEW	20	80	65	POA	POA
1	NEW	10	40	88	POA	POA
1-1/4		12	24	160	61.77	85.60
1-1/2	NEW	10	20	213	POA	POA
2	NEW	6	12	325	POA	POA
2-1/2	NEW	1	4	586	POA	POA
3	NEW	1	1	915	POA	POA
4	NEW	1	1	1,570	POA	POA

PIECES ORDERED		SIZE IN INCHES	PCS. PER BOX	PCS. PER MASTER CARTON	WGHT PER 100	PRICE PER PIECE	
BLACK	GALV.					BLACK	GALV.

**MALLEABLE IRON CAPS**

Fig. 49



	1/4	40	240	6	★ 5.40	★ 7.33	
	3/8	40	240	10	★ 4.53	★ 7.33	
	1/2	50	300	17	★ 4.10	★ 6.06	
	3/4	40	240	24	★ 5.56	★ 8.38	
	1	25	150	42	★ 6.72	★ 10.39	
	1-1/4	25	100	62	★ 8.86	★ 13.67	
	1-1/2	20	80	83	★ 12.18	★ 17.52	
	2	10	40	129	★ 17.76	★ 24.54	
	2-1/2	6	12	189	40.46	71.27	
	3	6	12	291	★ 60.12	86.38	
	3-1/2	<b>NEW</b>	8	16	322	POA	POA
	4	<b>NEW</b>	5	10	566	103.08	190.81
	5	<b>NEW</b>	4	8	740	POA	POA
	6	<b>NEW</b>	1	1	995	POA	POA

PIECES ORDERED		SIZE IN INCHES	PCS. PER BOX	PCS. PER MASTER CARTON	WGHT PER 100	PRICE PER PIECE	
BLACK	GALV.					BLACK	GALV.

**MALLEABLE IRON FLOOR FLANGES (continued)** Fig. 15



	2 x 5-1/2	15	30	214	★ 36.80	★ 93.37
	2-1/2 x 5-13/16	10	10	225	40.38	113.51
	3 x 6-3/8	10	10	286	50.99	110.78

**MALLEABLE RIGHT & LEFT HAND THREAD COUPLINGS** Fig. 53



	1/2	40	240	21	★ 11.77	15.42
	3/4	40	160	33	★ 13.21	17.85
	1	25	100	50	★ 19.62	26.31
	1-1/4	15	60	74	★ 23.28	33.76
	1-1/2	10	40	101	★ 31.74	43.41
	2	8	32	154	★ 42.45	58.51

**MALLEABLE IRON LOCKNUTS**

Fig. 55

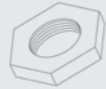

	1/8 (steel)	100	600	2	5.63	6.40
	1/4 (steel)	100	600	3	★ 5.18	★ 5.18
	3/8	50	300	4	★ 6.76	8.48
	1/2	50	300	7	★ 5.80	6.86
	3/4	50	300	10	★ 6.33	8.04
	1	40	160	16	★ 12.13	14.62
	1-1/4	40	160	22	★ 9.97	14.03
	1-1/2	40	160	27	★ 14.01	18.21
	2	25	100	55	★ 23.23	32.07

**MALLEABLE IRON 90° ELBOWS CLASS 300 & A.A.R.**

Fig. 65



	1/4	35	210	22	★ 20.56	36.80	
	3/8	20	120	32	★ 18.25	37.54	
	1/2	15	90	55	★ 23.66	★ 44.71	
	3/4	12	48	87	★ 26.76	★ 50.19	
	1	10	40	127	★ 34.18	★ 64.36	
	1-1/4	10	20	203	★ 49.87	101.10	
	1-1/2	8	16	265	★ 58.80	★ 109.58	
	2	5	10	413	★ 84.59	★ 184.14	
	3	6	6	1,032	251.77	483.38	
	3/8 x 1/4	25	150	25	42.16	POA	
	1/2 x 3/8	25	100	58	43.75	POA	
	3/4 x 1/2	15	60	69	32.24	57.21	
	1 x 1/2	<b>NEW</b>	20	40	137	POA	POA
	1 x 3/4	<b>NEW</b>	10	40	111	64.52	90.43
	1-1/4 x 3/4	<b>NEW</b>	15	30	135	POA	POA
	1-1/4 x 1	<b>NEW</b>	15	30	155	POA	POA
	1-1/2 x 1	<b>NEW</b>	10	20	185	POA	POA
	1-1/2 x 1-1/4	<b>NEW</b>	10	20	215	POA	POA
	2 x 1-1/4	<b>NEW</b>	5	10	302	POA	POA
	2 x 1-1/2	<b>NEW</b>	6	12	333	POA	POA
	4	<b>NEW</b>	1	1	1,635	POA	POA

**MALLEABLE IRON WASTE NUTS** Fig. 62



	1/2	50	300	10	12.00	13.81
	3/4	50	300	12	14.47	19.63
	1	25	150	15	10.83	14.54

**MALLEABLE IRON EXTENSION PIECES** Fig. 54



	3/8	100	400	12	POA	POA
	1/2	50	200	23	★ 12.52	20.16
	3/4	50	200	32	★ 18.46	30.16
	1	25	100	49	★ 26.63	37.82
	1-1/4	15	60	93	★ 30.64	40.56

**MALLEABLE IRON FLOOR FLANGES** Fig. 15



	1/4 x 2-3/8	25	150	24	12.57	24.43
	3/8 x 2-15/16	25	150	40	12.57	24.43
	1/2 x 3	30	120	46	★ 18.93	★ 47.30
	3/4 x 3-1/4	30	120	47	★ 18.93	★ 47.30
	1 x 3-7/8	30	60	91	★ 23.78	★ 43.17
	1-1/4 x 3-7/8	30	60	80	★ 23.78	★ 57.38
	1-1/2 x 4-1/2	10	40	140	★ 30.59	★ 73.52

**MALLEABLE IRON 45° ELBOWS CLASS 300 & A.A.R.** Fig. 65A



	1/4	35	210	17	30.59	43.59	
	3/8	25	150	34	30.59	43.59	
	1/2	20	80	51	★ 34.05	66.42	
	3/4	15	60	76	★ 37.88	76.78	
	1	10	40	119	★ 41.89	83.88	
	1-1/4	12	24	178	★ 67.15	130.19	
	1-1/2	8	16	236	★ 87.53	168.45	
	2	6	12	392	★ 132.26	233.34	
	2-1/2	<b>NEW</b>	4	8	530	POA	POA
	3	<b>NEW</b>	3	6	825	POA	POA
	4	<b>NEW</b>	1	3	1,341	POA	POA

PIECES ORDERED		SIZE IN INCHES	PCS. PER BOX	PCS. PER MASTER CARTON	WGHT PER 100	PRICE PER PIECE	
BLACK	GALV.					BLACK	GALV.

**MALLEABLE IRON STREET 90° ELBOWS CLASS 300 & A.A.R. Fig. 65B**



	1/4	40	240	19	24.33	38.73
	3/8	35	140	31	27.29	38.73
	1/2	15	90	48	★ 31.81	75.89
	3/4	12	48	76	★ 45.18	80.59
	1	10	40	111	★ 52.97	105.40
	1-1/4	12	24	176	★ 72.87	137.67
	1-1/2	10	20	133	★ 90.03	176.98
	2	6	12	376	★ 140.12	276.61
	3	<b>NEW</b> 2	4	973	POA	POA

**MALLEABLE IRON STREET 45° ELBOWS CLASS 300 & A.A.R.**



	1/2	12	24	36	55.95	POA
	3/4	30	120	52	61.10	POA
	1	15	60	85	71.65	POA
	1 1/4	10	40	150	87.63	POA
	1 1/2	6	24	206	128.81	POA
	2	8	16	334	219.18	POA

**MALLEABLE IRON TEES CLASS 300 & A.A.R. Fig. 66**



	1/4	25	150	32	25.89	52.38
	3/8	15	90	45	27.41	53.35
	1/2	15	60	75	★ 34.92	★ 66.79
	3/4	10	40	120	★ 37.68	★ 73.56
	1	12	24	171	★ 45.33	★ 90.70
	1-1/4	8	16	273	★ 64.97	129.45
	1-1/2	6	12	369	★ 75.76	★ 134.60
	2	4	8	559	★ 111.83	★ 215.18
	3	4	4	1,305	387.48	771.16
	3/8 x 1/4	18	108	43	31.81	POA
	1/2 x 3/8	15	60	68	59.14	90.49
	1/2 x 1/4	20	80	58	37.29	90.49
	3/4 x 1/4	<b>NEW</b> 15	60	73	POA	POA
	3/4 x 3/8	<b>NEW</b> 13	52	80	POA	POA
	3/4 x 1/2	10	40	100	★ 55.66	97.7
	3/4 x 1/2 x 1/2	<b>NEW</b> 1	1	78	POA	POA
	3/4 x 1/2 x 3/4	<b>NEW</b> 13	52	93	POA	POA
	1 x 1/2 x 1	<b>NEW</b> 18	36	130	POA	POA
	1 x 1/4	<b>NEW</b> 9	36	105	POA	POA
	1 x 3/4	7	28	155	★ 68.03	128.33
	1 x 3/4 x 3/4	<b>NEW</b> 10	40	123	POA	POA
	1 x 3/4 x 1	<b>NEW</b> 9	36	136	POA	POA
	1 x 1/2	8	32	141	★ 68.03	★ 116.63
	1-1/4 x 1/2	<b>NEW</b> 15	30	180	POA	POA
	1-1/4 x 1	10	20	228	★ 94.00	170.27
	1-1/4 x 1 x 1	<b>NEW</b> 14	28	193	POA	POA
	1-1/4 x 3/4	10	20	239	90.57	170.27
	1-1/2 x 1	8	16	298	★ 110.21	208.98
	1-1/2 x 1-1/4	<b>NEW</b> 9	18	305	POA	POA
	1-1/2 x 3/4	9	18	262	★ 110.21	208.98
	2 x 1/2	6	12	363	★ 177.68	★ 333.33
	2 x 3/4	8	16	386	177.68	333.33

PIECES ORDERED		SIZE IN INCHES	PCS. PER BOX	PCS. PER MASTER CARTON	WGHT PER 100	PRICE PER PIECE	
BLACK	GALV.					BLACK	GALV.

**MALLEABLE IRON TEES CLASS 300 & A.A.R. (continued) Fig. 66**



	2 x 1	6	12	421	177.68	281.70
	2 x 1-1/4	<b>NEW</b> 6	12	425	POA	POA
	2 x 1-1/2	5	10	483	★ 165.24	309.61
	2 x 1-1/2 x 2	<b>NEW</b> 5	10	470	POA	POA
	2-1/2	<b>NEW</b> 4	4	840	POA	POA
	2-1/2 x 1-1/2	<b>NEW</b> 4	8	653	POA	POA
	2-1/2 x 2	<b>NEW</b> 1	1	760	POA	POA
	3 x 2	<b>NEW</b> 4	4	990	773.23	1387.65
	4	<b>NEW</b> 1	1	2,340	POA	POA

**MALLEABLE IRON CROSSES CLASS 300 & A.A.R. Fig. 68**



	1/4	<b>NEW</b> 1	1	35	POA	POA
	1/2	12	48	89	97.22	173.89
	3/4	15	30	136	★ 114.65	253.14
	1	12	24	199	125.06	285.16
	1-1/4	7	14	311	126.86	260.83
	1-1/2	5	10	427	★ 218.80	349.30
	2	3	6	665	★ 238.25	498.78

**MALLEABLE IRON COUPLINGS & REDUCING COUPLINGS CLASS 300 & A.A.R. Fig. 67**



	1/4	35	210	18	18.54	24.14
	3/8	25	150	31	18.54	34.75
	1/2	20	80	48	★ 20.69	35.64
	3/4	30	60	74	★ 23.80	40.26
	1	10	40	110	★ 27.23	53.27
	1-1/4	12	24	174	★ 32.37	69.42
	1-1/2	10	20	223	★ 48.47	97.97
	2	6	12	365	★ 69.81	★ 118.65
	2-1/2	<b>NEW</b> 5	10	535	POA	POA
	3/8 x 1/4	25	150	25	24.51	34.77
	1/2 x 3/8	30	120	39	★ 29.51	50.37
	1/2 x 1/4	20	120	35	★ 29.51	50.37
	3/4 x 1/4	<b>NEW</b> 45	90	45	POA	POA
	3/4 x 3/8	<b>NEW</b> 45	90	47	POA	POA
	3/4 x 1/2	20	80	55	★ 30.18	61.13
	1 x 1/4	<b>NEW</b> 15	60	67	POA	POA
	1 x 1/2	15	60	78	★ 36.76	74.5
	1 x 3/4	12	48	83	★ 36.05	73.02
	1 x 3/8	<b>NEW</b> 20	80	65	POA	POA
	1-1/4 x 1/2	<b>NEW</b> 22	44	107	POA	POA
	1-1/4 x 3/4	15	30	123	★ 49.24	91.26
	1-1/4 x 1	18	36	134	★ 47.47	82.97
	1-1/2 x 1/2	<b>NEW</b> 16	32	147	POA	POA
	1-1/2 x 1	14	28	166	★ 65.01	113.09
	1-1/2 x 3/4	15	30	159	★ 67.52	113.09
	1-1/2 x 1-1/4	12	24	189	★ 73.94	124.76
	2 x 1-1/2	8	16	292	★ 93.47	161.83
	2 x 1/2	<b>NEW</b> 12	24	228	POA	POA
	2 x 3/4	<b>NEW</b> 10	20	235	POA	POA
	2 x 1	8	16	264	★ 94.26	181.32
	2-1/2 x 1-1/2	<b>NEW</b> 4	8	388	POA	POA

⊛ Preceding List Price Indicates Available In Master Quantity From Blossburg Factory    ★ Preceding List Price Indicates Available In Box Quantity Only From Blossburg Factory

PIECES ORDERED		SIZE IN INCHES		PCS. PER BOX	PCS. PER MASTER CARTON	WGHT PER 100	PRICE PER PIECE	
BLACK	GALV.	BLACK	GALV.				BLACK	GALV.

**MALLEABLE IRON COUPLINGS & REDUCING COUPLINGS CLASS 300 & A.A.R.**



(continued) Fig. 67

	2-1/2 x 2	<b>NEW</b>	5	10	437	POA	POA
	3	<b>NEW</b>	3	6	713	POA	POA
	3 x 1-1/2	<b>NEW</b>	4	8	560	POA	POA
	3 x 2	<b>NEW</b>	4	8	566	POA	POA
	3 x 2-1/2	<b>NEW</b>	4	8	643	POA	POA
	4 x 2	<b>NEW</b>	1	1	920	POA	POA
	4 x 3	<b>NEW</b>	4	4	985	POA	POA

**MALLEABLE IRON CAPS CLASS 300 & A.A.R.** Fig. 69



	1/4		50	300	13	19.02	24.62
	3/8		40	240	18	19.02	24.62
	1/2		40	160	28	18.86	36.13
	3/4		25	100	45	★ 23.80	43.19
	1		15	60	73	★ 31.22	59.26
	1-1/4		10	40	110	★ 34.59	70.12
	1-1/2		15	30	140	★ 50.54	98.30
	2		10	20	218	★ 70.22	136.04
	2-1/2	<b>NEW</b>	10	10	340	POA	POA
	3	<b>NEW</b>	8	16	463	POA	POA

**MALLEABLE IRON UNIONS BRASS TO IRON CLASS 150** Fig. 91



	1/8		25	150	27	★ 31.08	44.29
	1/4		35	210	24	★ 28.75	39.00
	3/8		30	180	32	★ 19.81	26.10
	1/2		40	160	41	⊕ 17.94	★ 23.81
	3/4		30	60	67	⊕ 20.62	★ 27.37
	3/4 x 1/2		40	160	41	36.59	45.53
	1		25	50	88	⊕ 26.87	★ 35.83
	1-1/4		15	30	151	★ 38.55	★ 51.81
	1-1/2		12	24	188	★ 48.07	★ 62.77
	2		8	16	265	★ 55.88	★ 72.17
	2-1/2		8	8	518	166.49	250.69
	3		8	8	763	200.42	350.87
	4		1	2	1,451	522.70	751.10

**MALLEABLE IRON UNIONS BRASS TO IRON CLASS 250** Fig. 92



	1/8		25	150	15	78.24	POA
	1/4		35	210	25	33.35	43.01
	3/8		30	180	38	33.58	43.64
	1/2		40	80	60	★ 33.66	★ 54.24
	3/4		30	60	102	★ 33.10	★ 49.27
	1		18	36	120	★ 40.62	61.1
	1-1/4		12	24	190	★ 68.14	★ 92.53
	1-1/2		10	20	243	★ 78.46	★ 106.52
	2		6	12	412	★ 100.65	★ 150.43
	2-1/2		8	8	540	315.48	395.72
	3		8	8	842	369.24	607.13
	4		1	2	1,451	654.46	952.38

PIECES ORDERED		SIZE IN INCHES		PCS. PER BOX	PCS. PER MASTER CARTON	WGHT PER 100	PRICE PER PIECE	
BLACK	GALV.	BLACK	GALV.				BLACK	GALV.

**MALLEABLE IRON UNION BRASS TO IRON CLASS 300 & A.A.R.** Fig. 93



	1/8		25	150	15	46.04	51.40
	1/4		35	210	25	42.01	57.06
	3/8		30	180	38	42.50	58.19
	1/2		40	80	57	★ 34.39	★ 55.18
	3/4		30	60	109	★ 38.08	★ 59.83
	1		18	36	129	★ 49.72	★ 79.37
	1-1/4		12	24	208	★ 81.08	★ 110.68
	1-1/2		10	20	252	★ 84.91	★ 133.26
	2		6	12	428	★ 105.16	★ 159.96
	2-1/2		8	8	541	339.07	446.19
	3		8	8	872	438.65	754.63
	4	<b>NEW</b>	1	1	1,730	POA	POA

**MALLEABLE IRON UNIONS ALL IRON CLASS 150** Fig. 94



	1/8		25	150	13	31.00	POA
	1/4		35	210	24	31.00	39.50
	3/8		35	210	30	31.00	39.50
	1/2		40	160	40	★ 32.02	42.04
	3/4		30	60	68	★ 36.29	★ 46.70
	1		25	50	88	★ 46.96	62.32
	1-1/4		15	30	149	★ 64.79	85.42
	1-1/2		12	24	182	★ 79.00	103.10
	2		8	16	260	★ 99.66	122.22
	2-1/2		8	8	520	206.84	317.62
	3		8	8	772	335.87	494.99

**MALLEABLE IRON UNIONS ALL IRON CLASS 300 & A.A.R.** Fig. 99



	1/8		25	150	16	49.35	62.95
	1/4		35	210	28	65.06	POA
	3/8		30	180	37	65.06	POA
	1/2		40	80	60	68.55	87.88
	3/4		30	60	107	★ 73.57	96.66
	1		18	36	125	★ 90.21	164.29
	1-1/4		15	30	206	★ 138.41	178.96
	1-1/2		10	20	253	★ 169.00	216.83
	2		5	10	418	213.88	269.04
	2-1/2		8	8	533	★ 379.02	POA
	3		8	8	854	720.38	POA

**MALLEABLE IRON UNIONS BRASS TO BRASS CLASS 300 & A.A.R.** Fig. 98



	1/4		30	180	26	39.97	55.88
	3/8		30	180	38	42.69	59.99
	1/2		25	100	57	★ 44.92	★ 62.18
	3/4		25	50	103	★ 50.28	★ 71.66
	1		18	36	130	★ 64.38	96.77
	1-1/4		15	30	208	★ 83.89	119.71
	1-1/2		12	24	252	★ 100.75	★ 148.32

⊕ Preceding List Price Indicates Available In Master Quantity From Blossburg Factory ★ Preceding List Price Indicates Available In Box Quantity Only From Blossburg Factory

PIECES ORDERED		SIZE IN INCHES	PCS. PER BOX	PCS. PER MASTER CARTON	WGHT PER 100	PRICE PER PIECE	
BLACK	GALV.					BLACK	GALV.
<b>MALLEABLE IRON UNIONS BRASS TO BRASS CLASS 300 &amp; A.A.R. (continued) Fig. 98</b>							
		2	5	10	417	★ 138.01	★ 198.40
		2-1/2	3	3	541	397.76	562.32
		3	3	3	872	484.15	POA
		4	1	2	1,517	988.59	1397.84



PIECES ORDERED		SIZE IN INCHES	PCS. PER BOX	PCS. PER MASTER CARTON	WGHT PER 100	PRICE PER PIECE	
BLACK	GALV.					BLACK	GALV.
<b>MALLEABLE IRON GASKET UNIONS CLASS 150 Fig. 95</b>							
		3/8	35	210	29	32.51	POA
		1/2	40	160	38	34.33	49.84
		3/4	30	60	65	38.73	54.55
		1	25	50	82	50.16	70.72
		1-1/4	15	30	141	69.27	97.25
		1-1/2	15	30	172	84.19	118.76
		2	8	16	262	105.01	146.22



PIECES ORDERED		SIZE IN INCHES	PCS. PER BOX	PCS. PER MASTER CARTON	WGHT PER 100	PRICE PER PIECE	
BLACK	GALV.					BLACK	GALV.
<b>TOP BEAM CLAMPS</b>							
		3/8 Small Mouth	100	100	31	★ 4.11	★ POA
		1/2 Small Mouth	100	100	46	★ 6.72	★ POA
		3/8 Wide Mouth	100	100	52	★ 8.11	★ POA
		1/2 Wide Mouth	100	100	50	★ 10.00	★ POA



PIECES ORDERED		SIZE IN INCHES	PCS. PER BOX	PCS. PER MASTER CARTON	WGHT PER 100	PRICE PER PIECE	
BLACK	GALV.					BLACK	GALV.
<b>DI-ELECTRIC UNIONS CLASS 150 Fig. 96</b>							
		1/2 W	40	160			45.71
		3/4 W	30	120			44.71



PIECES ORDERED		SIZE IN INCHES	PCS. PER BOX	PCS. PER MASTER CARTON	WGHT PER 100	PRICE PER PIECE	
BLACK	GALV.					BLACK	GALV.
<b>C-CLAMPS</b>							
		3/8 C-Clamp	100	100	28	★ 7.27	
		1/2 C-Clamp	100	100	28	★ 9.74	



PIECES ORDERED		SIZE IN INCHES	PCS. PER BOX	PCS. PER MASTER CARTON	WGHT PER 100	PRICE PER PIECE	
BLACK	GALV.					BLACK	GALV.

## PLUGS - REGULAR CORED

Figs. 01 & 02



	1/2	100	600	8	★ 3.00	★ 6.37
	3/4	70	420	15	★ 3.79	★ 8.10
	1	40	240	25	★ 3.79	★ 8.10
	1-1/4	40	160	43	★ 6.05	★ 13.52
	1-1/2	40	80	59	★ 8.56	★ 18.26
	2	25	50	94	★ 9.98	★ 22.68
	2-1/2	20	40	130	24.31	47.92
	3	10	20	198	★ 28.16	61.38
	3-1/2	10	20	208	68.70	112.08
	4 SQUARE HEAD	5	10	409	54.52	111.89
	4 BAR HEAD	5	10	399	★ 58.00	119.03
	5 BAR HEAD	5	5	627	109.03	236.65
	6 BAR HEAD	4	4	970	142.33	269.21

## PLUGS - SOLID

Figs. 03 & 04



	1/2	100	600	10	★ 3.36	★ 7.51
	3/4	50	300	17	★ 10.13	21.45
	1	30	180	33	★ 10.79	24.32
	1-1/4	30	120	57	★ 12.42	26.50
	1-1/2	40	80	80	★ 17.61	35.34
	2	25	50	125	22.73	50.35
	2-1/2	10	20	195	33.64	64.80
	3	10	20	328	57.39	114.31
	4 BAR HEAD	5	10	576	127.63	224.28
	5 BAR HEAD	5	5	970	237.22	POA

## COUNTERSUNK PLUGS

Fig. 05



	1/2 MI	100	600	6	6.87	10.34
	3/4 MI	80	480	10	9.34	16.09
	1 MI	40	240	22	13.08	25.70
	1-1/4	40	160	35	13.67	27.17
	1-1/2	50	100	48	16.37	36.53
	2	40	80	84	24.14	51.14
	2-1/2	20	40	150	38.16	75.99
	3	10	20	205	62.34	116.11
	3-1/2	10	20	258	POA	POA
	4	5	5	390	168.00	343.77

## HEX HEAD CLEANOUT PLUGS

Fig. 06



	1-1/4	1	1	28	7.50	POA
	4	1	1	172	47.36	121.37

PIECES ORDERED		SIZE IN INCHES	PCS. PER BOX	PCS. PER MASTER CARTON	WGHT PER 100	PRICE PER PIECE	
BLACK	GALV.					BLACK	GALV.

## HEXAGON BUSHINGS

Fig. 09



	3/8x1/4	25	150	3	★ 7.61	12.14
	1/2x3/8	25	150	6	★ 7.61	★ 12.14
	1/2x1/4	25	150	7	★ 7.61	12.14
	1/2x1/8	25	150	8	★ 7.61	12.14
	3/4 x 1/2	25	150	10	★ 6.59	10.99
	3/4 x 3/8	25	150	11	★ 7.32	★ 14.36
	3/4 x 1/4	25	150	12	★ 7.14	★ 12.84
	3/4 x 1/8	25	150	15	★ 7.52	★ 13.20
	1 x 3/4	25	150	17	★ 6.92	★ 12.63
	1 x 1/2	25	150	21	★ 7.03	★ 13.58
	1 x 3/8	25	150	18	★ 9.50	★ 15.08
	1 x 1/4	25	150	25	★ 9.24	★ 15.00
	1 x 1/8	25	150	21	★ 10.70	★ 17.66
	1-1/4 x 1	25	150	30	★ 9.04	★ 17.02
	1-1/4 x 3/4	25	150	38	★ 9.04	★ 17.02
	1-1/4 x 1/2	25	150	31	★ 10.28	★ 19.28
	1-1/4 x 3/8	25	150	34	★ 11.11	22.63
	1-1/4 x 1/4	25	150	36	13.28	22.63
	1-1/4 x 1/8	25	150	36	12.88	★ 22.09
	1-1/2 x 1-1/4	30	120	31	★ 11.48	★ 20.52
	1-1/2 x 1	30	120	47	★ 10.32	★ 21.41
	1-1/2 x 3/4	30	120	43	★ 11.76	★ 23.70
	1-1/2 x 1/2	30	120	40	★ 11.76	★ 23.70
	1-1/2 x 3/8	30	120	47	★ 17.54	★ 30.48
	1-1/2 x 1/4	15	90	49	★ 15.47	★ 30.48
	1-1/2 x 1/8	30	120	62	14.44	27.36
	2 x 1-1/2	20	80	61	★ 14.44	★ 23.81
	2 x 1-1/4	20	80	85	★ 14.12	★ 27.60
	2 x 1	20	80	75	★ 14.12	★ 27.60
	2 x 3/4	20	80	61	★ 14.77	★ 27.60
	2 x 1/2	20	80	60	★ 18.68	★ 29.70
	2 x 3/8	20	80	75	★ 21.00	35.34
	2 x 1/4	20	80	73	★ 16.68	34.52
	2-1/2 x 2	20	20	113	★ 22.25	39.63
	2-1/2 x 1-1/2	20	20	111	22.60	45.25
	2-1/2 x 1-1/4	20	20	105	25.98	50.27
	2-1/2 x 1	20	20	90	25.98	50.27
	2-1/2 x 3/4	20	20	120	25.98	50.27
	2-1/2 x 1/2	20	20	102	24.22	50.27
	3 x 2-1/2	10	10	161	30.41	55.37
	3 x 2	10	20	164	26.23	51.58
	3 x 1-1/2	10	20	157	35.12	59.69
	3 x 1-1/4	10	20	152	35.12	64.78
	3 x 1	10	20	168	35.12	66.32
	3 x 3/4	10	20	190	38.16	66.32
	3 x 1/2	10	20	155	39.10	66.32
	3 x 1/4	10	20	197	32.11	61.53
	3-1/2 x 3	10	10	247	61.56	117.78
	3-1/2 x 2-1/2	10	10	198	68.39	117.78
	3-1/2 x 2	10	10	190	66.77	117.78
	3-1/2 x 1-1/2	10	10	234	68.39	117.78
	3-1/2 x 1-1/4	10	10	212	68.39	107.50
	3-1/2 x 1	10	10	219	68.39	POA
	4 x 3-1/2	10	10	200	79.59	139.00
	4 x 3	10	10	318	59.16	108.28
	4 x 2-1/2	10	10	280	71.59	139.00

PIECES ORDERED		SIZE IN INCHES	PCS. PER BOX	PCS. PER MASTER CARTON	WGHT PER 100	PRICE PER PIECE	
BLACK	GALV.					BLACK	GALV.

**HEXAGON BUSHINGS**

(continued) Fig. 09



	4 x 2	10	10	270	59.16	108.28
	4 x 1-1/2	10	10	286	73.29	139.00
	4 x 1-1/4	10	10	250	79.59	139.00
	4 x 1	10	10	273	79.59	139.00
	4 x 1/2	10	10	291	73.06	129.01
	5 x 4	10	10	474	120.47	229.50
	5 x 3-1/2	10	10	525	POA	POA
	5 x 3	10	10	496	124.04	235.00
	5 x 2-1/2	10	10	543	137.87	214.51
	5 x 2	10	10	445	137.87	235.00
	5 x 1-1/2	10	10	485	POA	POA
	6 x 5	6	6	617	142.21	265.85
	6 x 4	6	6	788	123.13	250.80
	6 x 3	6	6	752	142.23	265.85
	6 x 2-1/2	6	6	620	158.08	267.52
	6 x 2	6	6	650	142.23	265.85
	8 x 6	2	2	1,112	268.00	463.44
	8 x 4	2	2	1,828	297.71	499.12

**TANK BUSHINGS, DOUBLE TAPPED HEAVY TYPE ONLY**

Fig. 13



	1 x 1/2 x 1/2	50	50	37	14.86	24.83
	1-1/2 x 1 x 1	40	40	66	21.64	36.10
	2 x 1-1/2 x 1-1/2	20	20	89	29.20	48.66
	2 x 1-1/4 x 1-1/4	20	20	120	29.20	48.66
	2 x 1 x 1	20	20	136	29.20	48.66
	2 x 3/4 x 3/4	20	20	155	29.20	48.66
	2 x 1/2 x 1/2	20	20	165	29.20	48.66
	2 x 3/8 x 3/8	20	20	174	29.20	POA
	3 x 2 x 2	10	10	350	59.18	96.48
	3 x 1 x 1	10	10	525	59.18	96.48
	4 x 3 x 3	5	5	425	116.11	193.61
	4 x 2-1/2 x 2-1/2	5	5	601	107.04	178.60
	4 x 2 x 2	5	5	349	107.04	178.60
	4 x 1-1/2 x 1-1/2	5	5	334	107.04	178.60
	4 x 1 x 1	5	5	650	107.04	178.60

PIECES ORDERED		SIZE IN INCHES	PCS. PER BOX	PCS. PER MASTER CARTON	WGHT PER 100	PRICE PER PIECE	
BLACK	GALV.					BLACK	GALV.

**FLUSH BUSHINGS**

Fig. 10



	1 x 3/4	25	150	12	★ 18.28	★ 30.81
	1 x 1/2	25	150	14	★ 14.71	★ 30.81
	1-1/4 x 1	25	150	18	★ 19.77	★ 38.13
	1-1/4 x 3/4	25	150	27	14.90	40.28
	1-1/4 x 1/2	25	150	30	15.34	40.28
	1-1/2 x 1-1/4	30	120	20	★ 24.67	★ 54.66
	1-1/2 x 1	30	120	32	★ 24.35	★ 54.02
	1-1/2 x 3/4	30	120	40	27.37	55.78
	1-1/2 x 1/2	30	120	45	27.37	55.63
	2 x 1-1/2	20	80	40	★ 33.23	★ 72.01
	2 x 1-1/2	20	80	40	★ 25.74	★ 55.78
	2 x 1-1/4	20	80	54	31.92	69.25
	2 x 1	20	80	62	★ 31.92	★ 69.25
	2 x 3/4	20	80	70	31.08	67.45
	2 x 1/2	20	80	66	36.05	76.45
	2-1/2 x 2	20	20	56	47.00	96.06
	2-1/2 x 1-1/4	20	20	100	34.62	POA
	3 x 2-1/2	10	10	95	69.16	144.84
	3 x 2	10	10	134	77.43	129.68
	3 x 1-1/2	10	10	95	76.11	POA
	3 x 1-1/4	10	10	95	72.58	POA
	3-1/2 x 1-1/2	10	10			206.54
	3-1/2 x 2-1/2	10	10	171	104.46	199.41
	3-1/2 x 2	10	10	237	POA	199.41
	4 x 3-1/2	10	10	115	149.94	POA
	4 x 3	10	10	200	147.32	278.12
	4 x 2-1/2	10	10	252	134.46	278.12
	4 x 2	10	10	280	177.90	POA
	5 x 4	10	10	300	177.90	POA
	6 x 5	6	6	375	273.23	POA
	6 x 4	6	6	550	284.18	548.29
	8 x 6	2	2	925	737.00	1521.58
	6 x 4	6	6	350	214.07	413.04
	8 x 6	2	2	800	555.19	1146.22

★ Preceding List Price Indicates Available In Master Quantity From Blossburg Factory    ★ Preceding List Price Indicates Available In Box Quantity Only From Blossburg Factory

PIECES ORDERED		SIZE IN INCHES	PCS. PER BOX	PCS. PER MASTER CARTON	WGHT PER 100	PRICE PER PIECE	
BLACK	GALV.					BLACK	GALV.

PIECES ORDERED		SIZE IN INCHES	PCS. PER BOX	PCS. PER MASTER CARTON	WGHT PER 100	PRICE PER PIECE	
BLACK	GALV.					BLACK	GALV.

**CAST IRON 90° ELBOWS**

Fig. 21



	1/4		25	150	17	★	11.91	19.94
	3/8		25	150	25	★	17.23	19.94
	1/2		100	100	41	★	7.55	22.73
	3/4		100	100	69	★	7.87	22.31
	1		50	50	105	★	9.31	25.78
	1-1/4		25	25	158	★	13.22	40.13
	1-1/2		25	25	209	★	18.28	55.11
	2		15	15	339	★	28.57	81.38
	2-1/2		10	10	514	★	68.45	167.02
	3		6	6	787		112.09	254.05
	3-1/2		3	3	955		304.46	POA
	4		2	2	1,323		207.82	465.47
	5	<b>NEW</b>	1	1	2,040		POA	POA
	6	<b>NEW</b>	1	1	2,985		POA	POA
	8	<b>NEW</b>	1	1	6,456		POA	POA
	3/4 x 1/2		100	100	56	★	15.87	25.81
	3/4 x 3/8				-			25.81
	1/2 x 1/4	<b>NEW</b>	1	1	40		POA	POA
	1/2 x 3/8	<b>NEW</b>	100	100	34		POA	POA
	1 x 1/2		50	50	71	★	11.76	28.3
	1 x 3/4		50	50	92	★	13.25	29.91
	1-1/4 x 1		25	25	127	★	16.68	43.86
	1-1/4 x 3/4		25	25	115	★	19.02	POA
	1-1/4 x 1/2		25	25	100	★	18.71	46.41
	1-1/2 x 1-1/4		25	25	190	★	33.69	POA
	1-1/2 x 1		25	25	157	★	30.79	POA
	1-1/2 x 3/4		25	25	146	★	30.79	POA
	1-1/2 x 1/2		25	25	147	★	33.04	68.10
	2 x 1-1/2		15	15	274	★	45.08	POA
	2 x 1-1/4		15	15	249	★	48.20	96.42
	2 x 1		15	15	227	★	45.08	96.42
	2 x 3/4		15	15	206	★	45.08	96.42
	2 x 1/2		15	15	204	★	51.36	96.42
	2-1/2 x 2		10	10	400		91.04	POA
	2-1/2 x 1-1/2		10	10	326		102.66	POA
	4 x 3		4	4	1,067		293.25	POA
	4 x 2-1/2		4	4	890		293.25	515.53
	4 x 2		4	4	775		293.25	POA
	4 x 1-1/2		4	4	850		287.13	515.53
	2-1/2 x 1-1/4		10	10	326		105.13	184.85
	2-1/2 x 1		10	10	258		105.13	184.85
	2-1/2 x 3/4		10	10	280		102.91	184.85
	3 x 2-1/2		6	6	574		171.87	298.70
	3 x 2		6	6	575		158.33	POA
	3 x 1-1/2		6	6	603		171.87	298.70
	3 x 1-1/4		6	6	465		171.87	POA
	3 x 1		6	6	475		168.32	POA
	5 x 4	<b>NEW</b>	1	1	1,690		POA	POA
	6 x 3	<b>NEW</b>	1	1	2,038		POA	POA
	6 x 4	<b>NEW</b>	1	1	2,465		POA	POA

**CAST IRON 45° ELBOWS**

Fig. 23



	1/4	<b>NEW</b>	1	1	16		POA	POA
	3/8	<b>NEW</b>	1	1	25		POA	POA
	1/2		100	100	36	★	11.55	22.72
	3/4		100	100	60	★	11.62	26.05
	1		50	50	87	★	13.62	32.03
	1-1/4		25	25	140	★	18.32	47.82
	1-1/2		25	25	180	★	30.36	67.60
	2		15	15	298	★	35.02	94.80
	2-1/2		10	10	462		91.07	POA
	3		6	6	655		144.24	298.11
	4		2	2	992		299.87	546.61
	5	<b>NEW</b>	1	1	1,696		POA	POA
	6	<b>NEW</b>	1	1	2,530		POA	POA

**CAST IRON STRAIGHT TEES**

Fig. 24



	1/4		1	1	22		18.62	POA
	3/8		25	150	38	★	18.10	★ POA
	1/2		100	100	55	★	11.76	23.20
	3/4		50	50	92	★	13.73	32.09
	1		25	50	142	★	12.20	34.84
	1-1/4		25	25	223	★	22.28	60.96
	1-1/2		25	25	287	★	28.95	80.64
	2		15	15	469	★	40.32	100.6
	2-1/2		9	9	675		104.75	POA
	3		5	5	994		160.75	POA
	3-1/2		3	3	1,246		324.22	575.59
	4		2	2	1,737		313.56	644.98
	5	<b>NEW</b>	1	1	2,718		POA	POA
	6	<b>NEW</b>	1	1	3,960		POA	POA

★ Preceding List Price Indicates Available In Master Quantity From Blossburg Factory ★ Preceding List Price Indicates Available In Box Quantity Only From Blossburg Factory

PIECES ORDERED	SIZE IN INCHES	PCS. PER BOX	PCS. PER MASTER CARTON	WGHT PER 100	PRICE PER PIECE	
					BLACK	GALV.

PIECES ORDERED	SIZE IN INCHES	PCS. PER BOX	PCS. PER MASTER CARTON	WGHT PER 100	PRICE PER PIECE	
					BLACK	GALV.

**CAST IRON REDUCING TEES**

Fig. 25



	1/2 x 1/2 x 1/4	NEW	1	1	60	POA	POA
	1/2 x 1/2 x 3/8		25	25	55	24.45	POA
	1/2 x 1/2 x 3/4		50	50	99	★ 22.13	36.73
	1/2 x 1/2 x 1	NEW	1	1	88	POA	POA
	3/4 x 3/4 x 1/4	NEW	1	1	62	POA	POA
	3/4 x 3/4 x 1/2		50	50	81	★ 19.07	POA
	3/4 x 3/4 x 3/8		50	50	81	22.71	36.73
	3/4 x 1/2 x 3/4		50	50	96	★ 22.13	POA
	3/4 x 1/2 x 1/2		50	50	66	★ 22.13	POA
	3/4 x 3/4 x 1		45	45	121	★ 22.39	45.26
	1 x 1 x 3/4		50	50	126	★ 16.52	40.75
	1 x 1 x 1/2		50	50	108	★ 13.75	42.10
	1 x 1 x 3/8		50	50	116	22.31	42.10
	1 x 3/4 x 1		50	50	126	★ 18.42	POA
	1 x 3/4 x 3/4		50	50	100	★ 22.99	POA
	1 x 3/4 x 1/2		50	50	97	25.05	41.58
	1 x 1/2 x 1		50	50	109	★ 18.14	38.59
	1 x 1/2 x 3/4		50	50	100	25.05	41.58
	1 x 1/2 x 1/2		50	50	84	27.48	POA
	1 x 1 x 1/4	NEW	1	1	85	POA	POA
	1 x 1/4 x 1		50	50	106	28.63	45.26
	1 x 1 x 2	NEW	1	1	225	POA	POA
	1 x 1 x 1-1/4		25	25	164	★ 26.40	67.06
	1 x 1/2 x 1-1/4		25	25	187	51.43	68.39
	1 x 3/4 x 1-1/4		25	25	202	51.43	68.39
	1-1/4 x 1/2 x 1-1/4		25	25	181	★ 34.03	POA
	1-1/4 x 1/2 x 1-1/2		25	25	230	47.78	92.88
	1-1/4 x 1/2 x 1		25	25	185	★ 39.94	POA
	1-1/4 x 1/2 x 3/4		25	25	144	40.01	68.39
	1-1/4 x 1/2 x 1/2		25	25	110	52.50	68.39
	1-1/4 x 3/4 x 1-1/2		25	25	230	43.22	98.96
	1-1/4 x 3/4 x 1-1/4		25	25	177	★ 32.45	POA
	1-1/4 x 3/4 x 1		25	25	172	★ 39.77	68.39
	1-1/4 x 3/4 x 3/4		25	25	136	★ 39.77	POA
	1-1/4 x 3/4 x 1/2		25	25	150	39.77	68.39
	1-1/4 x 1-1/4 x 1-1/2		25	25	278	★ 40.82	95.27
	1-1/4 x 1-1/4 x 1		25	25	185	★ 22.01	63.37
	1-1/4 x 1-1/4 x 3/4		25	25	165	★ 23.89	POA
	1-1/4 x 1-1/4 x 1/2		25	25	164	★ 21.98	63.37
	1-1/4 x 1 x 1		25	25	164	★ 22.01	63.37
	1-1/4 x 1 x 1-1/4		25	25	195	★ 24.31	67.06
	1-1/4 x 1 x 1-1/2		25	25	270	★ 40.82	95.27
	1-1/4 x 1 x 2	NEW	1	1	267	POA	POA
	1-1/4 x 1 x 3/4		25	25	160	★ 25.21	67.06
	1-1/4 x 1 x 1/2		25	25	136	★ 22.29	63.37
	1-1/4 x 1-1/4 x 2	NEW	1	1	290	POA	POA
	1-1/2 x 3/4 x 1/2		25	25	171	44.71	95.75
	1-1/2 x 3/4 x 3/4		25	25	166	44.71	95.75
	1-1/2 x 3/4 x 1		25	25	192	44.71	POA
	1-1/2 x 3/4 x 1-1/4		25	25	230	★ 44.47	95.75
	1-1/2 x 3/4 x 1-1/2		25	25	228	★ 44.45	POA
	1-1/2 x 1/2 x 1-1/4		25	25	235	★ 51.72	92.88
	1-1/2 x 1/2 x 1-1/2		25	25	217	★ 45.52	92.88
	1-1/2 x 1/2 x 1/2		25	25	158	52.03	92.69
	1-1/2 x 1/2 x 3/4		25	25	155	52.03	92.69
	1-1/2 x 1 x 1/2		25	25	191	★ 47.23	92.88
	1-1/2 x 1 x 3/4		25	25	192	★ 45.69	92.88
	1-1/2 x 1 x 1		25	25	189	★ 40.82	POA
	1-1/2 x 1 x 1-1/4		25	25	271	★ 47.23	92.88

**CAST IRON REDUCING TEES**

(continued) Fig. 25



	1-1/2 x 1 x 1-1/2		25	25	253	★ 34.04	91.14
	1-1/2 x 1 x 2		15	15	411	★ 63.77	126.87
	1-1/2 x 1-1/4 x 1/2		25	25	178	★ 31.01	86.19
	1-1/2 x 1-1/4 x 3/4		25	25	204	★ 32.79	91.14
	1-1/2 x 1-1/4 x 1		25	25	218	★ 28.70	86.19
	1-1/2 x 1-1/4 x 1-1/4		25	25	236	★ 40.82	95.27
	1-1/2 x 1-1/4 x 1-1/2		25	25	271	★ 40.82	95.27
	1-1/2 x 1-1/4 x 2		15	15	430	★ 62.49	124.48
	1-1/2 x 1-1/2 x 1/2		25	25	200	★ 28.70	86.19
	1-1/2 x 1-1/2 x 3/4		25	25	217	★ 31.01	86.19
	1-1/2 x 1-1/2 x 1		25	25	228	★ 28.70	86.19
	1-1/2 x 1-1/2 x 1-1/4		25	25	262	★ 40.82	95.27
	1-1/2 x 1-1/2 x 2		15	15	355	★ 44.65	124.48
	1-1/2 x 1-1/2 x 2-1/2		10	10	425	★ 137.73	241.33
	2 x 2 x 1-1/2		15	15	396	★ 48.29	124.48
	2 x 2 x 1-1/4		15	15	364	★ 45.68	117.69
	2 x 2 x 1		15	15	326	★ 40.68	117.69
	2 x 2 x 3/4		15	15	310	★ 40.68	117.69
	2 x 2 x 1/2		15	15	290	★ 40.68	117.69
	2 x 1-1/2 x 2		15	15	400	★ 55.47	POA
	2 x 1-1/2 x 1-1/2		15	15	346	★ 62.49	122.36
	2 x 1-1/2 x 1-1/4		15	15	363	★ 63.72	POA
	2 x 1-1/2 x 1		15	15	289	★ 40.68	117.69
	2 x 1-1/2 x 3/4		15	15	273	★ 46.57	117.69
	2 x 1-1/2 x 1/2		15	15	239	★ 46.57	117.69
	2 x 1-1/4 x 2		15	15	396	★ 55.47	POA
	2 x 1-1/4 x 1-1/2		15	15	363	★ 73.41	126.87
	2 x 1-1/4 x 1-1/4		15	15	300	★ 63.77	POA
	2 x 1-1/4 x 1		15	15	310	★ 71.66	126.87
	2 x 1-1/4 x 1/2		15	15	244	73.41	POA
	2 x 1-1/4 x 3/4	NEW	1	1	250	POA	POA
	2 x 1 x 2		15	15	370	★ 64.28	117.69
	2 x 1 x 1-1/2		15	15	413	★ 59.62	126.87
	2 x 1 x 1-1/4		15	15	300	73.41	126.87
	2 x 1 x 1		15	15	240	★ 71.66	POA
	2 x 1 x 3/4		15	15	250	★ 71.67	126.87
	2 x 3/4 x 2		15	15	380	★ 58.26	124.09
	2 x 3/4 x 1-1/2		15	15	410	★ 73.41	POA
	2 x 3/4 x 1-1/4		15	15	424	73.41	126.87
	2 x 3/4 x 1		15	15	250	73.41	126.87
	2 x 3/4 x 3/4		15	15	210	POA	POA
	2 x 1/2 x 2		15	15	330	★ 63.77	POA
	2 x 1/2 x 1-1/2		15	15	314	★ 73.41	126.87
	2 x 1/2 x 1-1/4		15	15	341	★ 73.41	POA
	2 x 1/2 x 1/2		15	15	220	POA	POA
	2-1/2 x 2-1/2 x 3		6	6	958	206.99	382.08
	2-1/2 x 2 x 3		6	6	888	206.99	POA
	2-1/2 x 2-1/2 x 2		10	10	610	118.78	POA
	2-1/2 x 2-1/2 x 1-1/2		10	10	500	121.60	241.33
	2-1/2 x 2-1/2 x 1-1/4		10	10	450	118.78	POA
	2-1/2 x 2-1/2 x 1		10	10	469	116.47	POA
	2-1/2 x 2-1/2 x 3/4		10	10	475	118.78	POA
	2-1/2 x 2-1/2 x 1/2		10	10	490	132.02	241.33
	2-1/2 x 2 x 2-1/2		10	10	575	119.30	236.76
	2-1/2 x 2 x 2		10	10	537	121.60	POA
	2-1/2 x 2 x 1-1/2		10	10	574	132.02	POA
	2-1/2 x 2 x 1-1/4		10	10	412	137.73	POA
	2-1/2 x 2 x 1		10	10	440	118.78	241.33
	2-1/2 x 2 x 3/4		10	10	433	116.47	POA

★ Preceding List Price Indicates Available In Master Quantity From Blossburg Factory ★ Preceding List Price Indicates Available In Box Quantity Only From Blossburg Factory

PIECES ORDERED	SIZE IN INCHES	PCS. PER BOX	PCS. PER MASTER CARTON	WGHT PER 100	PRICE PER PIECE	
					BLACK	GALV.

PIECES ORDERED	SIZE IN INCHES	PCS. PER BOX	PCS. PER MASTER CARTON	WGHT PER 100	PRICE PER PIECE	
					BLACK	GALV.

**CAST IRON REDUCING TEES**  
(continued) Fig. 25



	2-1/2 x 2 x 1/2	10	10	350	137.73	241.33
	2-1/2 x 1-1/2 x 2-1/2	10	10	535	137.73	241.33
	2-1/2 x 1-1/2 x 2	10	10	558	137.73	241.33
	2-1/2 x 1-1/2 x 1-1/2	10	10	601	137.73	POA
	2-1/2 x 1-1/2 x 1-1/4	10	10	446	137.71	252.12
	2-1/2 x 1-1/2 x 1/2	10	10	376	POA	252.12
	2-1/2 x 1-1/4 x 2-1/2	10	10	520	137.73	POA
	2-1/2 x 1-1/4 x 2	10	10	557	137.73	POA
	2-1/2 x 1-1/4 x 1-1/4	10	10	380	137.71	252.12
	2-1/2 x 1-1/4 x 1	10	10	394	137.71	252.12
	2-1/2 x 1 x 2-1/2	10	10	525	121.60	236.76
	2-1/2 x 1 x 2	10	10	470	137.73	236.76
	2-1/2 x 1 x 1-1/4	10	10	388	137.71	236.76
	2-1/2 x 1 x 1	10	10	315	POA	POA
	2-1/2 x 1 x 3/4	10	10	280	POA	POA
	2-1/2 x 3/4 x 2-1/2	10	10	532	121.51	232.6
	2-1/2 x 3/4 x 2	10	10	440	121.51	236.76
	2-1/2 x 1/2 x 2-1/2	10	10	549	124.35	232.6
	2 x 2 x 3	6	6	922	186.76	363.79
	2 x 2 x 2-1/2	10	10	550	★ 103.57	POA
	2 x 1-1/2 x 2-1/2	10	10	628	118.88	241.33
	2 x 1-1/4 x 2-1/2	10	10	556	137.73	241.33
	2 x 1 x 2-1/2	10	10	560	137.73	241.33
	2 x 3/4 x 2-1/2	10	10	360	137.71	241.33
	3 x 3 x 2-1/2	6	6	775	206.99	POA
	3 x 3 x 2	6	6	800	178.03	POA
	3 x 3 x 1-1/2	6	6	840	206.99	POA
	3 x 3 x 1-1/4	6	6	584	190.73	POA
	3 x 3 x 1	6	6	660	174.34	POA
	3 x 2-1/2 x 3	6	6	850	206.99	363.79
	3 x 2-1/2 x 2-1/2	6	6	780	206.99	POA
	3 x 2-1/2 x 2	6	6	837	206.99	POA
	3 x 2-1/2 x 1-1/4	6	6	658	197.25	POA
	3 x 2 x 3	6	6	780	206.99	363.79
	3 x 2 x 2-1/2	6	6	850	197.25	POA
	3 x 2 x 2	6	6	615	206.99	POA
	3 x 2 x 1-1/2	6	6	650	206.99	363.79
	3 x 3 x 1/2	<b>NEW</b>	1	1	608	POA
	3 x 3 x 3/4	<b>NEW</b>	1	1	595	POA
	3 x 1-1/2 x 3	6	6	830	206.99	363.79
	3 x 1-1/2 x 2	6	6	650	207.00	382.08
	3 x 2-1/2 x 1-1/2	<b>NEW</b>	1	1	623	POA
	3 x 1-1/2 x 1-1/2	6	6	675	207.00	POA
	3 x 1-1/4 x 3	6	6	838	206.99	363.79
	3 x 1-1/4 x 2	6	6	600	198.34	POA
	3 x 1 x 3	6	6	822	206.99	363.79
	3 x 1 x 2	6	6	580	POA	POA
	3-1/2 x 3 x 3-1/2	3	3	1,375	POA	POA
	3-1/2 x 3 x 3	3	3	1,494	POA	POA
	3-1/2 x 3 x 2-1/2	3	3	950	POA	POA
	3-1/2 x 3 x 1-1/2	3	3	1,222	POA	POA
	3-1/2 x 1 x 3-1/2	3	3	1,030	POA	POA
	3 x 3 x 3-1/2	3	3	1,462	POA	POA
	3 x 3 x 4	<b>NEW</b>	1	1	1,280	POA
	4 x 4 x 3-1/2	3	3	1,775	POA	POA
	4 x 4 x 3	4	4	1,410	403.68	727.50
	4 x 4 x 2-1/2	4	4	1,238	380.84	POA
	4 x 4 x 2	4	4	1,117	364.52	727.50
	4 x 4 x 1-1/2	4	4	1,108	413.26	POA

**CAST IRON REDUCING TEES**  
(continued) Fig. 25



	4 x 3-1/2 x 4	2	2	1,805	415.83	865.97
	4 x 3 x 4	4	4	1,500	413.26	POA
	4 x 2-1/2 x 4	4	4	1,400	413.26	POA
	4 x 2 x 4	4	4	1,360	413.26	727.50
	4 x 4 x 3/4	<b>NEW</b>	1	1	1,058	POA
	4 x 4 x 1	<b>NEW</b>	1	1	980	POA
	4 x 4 x 1-1/4	<b>NEW</b>	1	1	978	POA
	4 x 1-1/2 x 4	4	4	1,325	393.80	727.50
	4 x 1 x 4	4	4	1,392	358.99	727.50
	4 x 3-1/2 x 2-1/2	4	4	1,344	POA	POA
	4 x 3 x 3	4	4	1,160	544.27	727.50
	4 x 3 x 2-1/2	4	4	1,270	393.80	727.50
	4 x 3 x 2	4	4	1,200	423.35	727.50
	4 x 3 x 1-1/2	4	4	1,058	POA	727.50
	4 x 2-1/2 x 2-1/2	4	4	1,083	506.35	POA
	4 x 2-1/2 x 2	4	4	1,096	POA	POA
	4 x 2 x 2	4	4	875	423.35	727.50
	5 x 5 x 2	<b>NEW</b>	1	1	1,743	POA
	5 x 5 x 2-1/2	<b>NEW</b>	1	1	2,093	POA
	5 x 5 x 3	<b>NEW</b>	1	1	2,000	POA
	5 x 5 x 4	<b>NEW</b>	1	1	2,383	POA
	6 x 6 x 3	<b>NEW</b>	1	1	2,670	POA
	6 x 6 x 4	<b>NEW</b>	1	1	3,043	POA
	6 x 6 x 5	<b>NEW</b>	1	1	3,523	POA

**CAST IRON REDUCING TEES**  
Fig. 25 Class 250



	1-1/4 x 1-1/4 x 3/4	<b>NEW</b>	1	1	321	POA
	1-1/2 x 1-1/2 x 3/4	<b>NEW</b>	1	1	402	POA
	2 x 2 x 3/4	<b>NEW</b>	1	1	615	POA
	2 x 2 x 1-1/2	<b>NEW</b>	1	1	760	POA

**CAST IRON CROSSES**  
Fig. 30A



	1/2	50	50	87	32.41	56.39
	3/4	30	30	130	32.41	POA
	1	25	25	178	★ 37.74	78.56
	1-1/4	15	15	295	★ 53.23	POA
	1-1/4 x 1	15	15	215	61.18	110.46
	1-1/2	10	10	350	★ 73.87	133.20
	1-1/2 x 1-1/4	<b>NEW</b>	1	1	280	POA
	1-1/2 x 1-1/4 x 1	<b>NEW</b>	1	1	303	POA
	1-1/2 x 1-1/4 x 1 x 1	<b>NEW</b>	1	1	268	POA
	1-1/2 x 1	10	10	262	72.75	134.49
	1-1/2 x 1 x 1 x 1	<b>NEW</b>	1	1	280	POA
	2	8	8	650	★ 97.82	209.30
	2 x 1	8	8	352	99.61	209.60
	2 x 1-1/4	<b>NEW</b>	1	1	373	POA
	2 x 1-1/2	<b>NEW</b>	1	1	410	POA
	2 x 1-1/2 x 1 x 1	<b>NEW</b>	1	1	367	POA
	4	<b>NEW</b>	1	1	1,950	POA

★ Preceding List Price Indicates Available In Master Quantity From Blossburg Factory ★ Preceding List Price Indicates Available In Box Quantity Only From Blossburg Factory

PIECES ORDERED	SIZE IN INCHES	PCS. PER BOX	PCS. PER MASTER CARTON	WGHT PER 100	PRICE PER PIECE	
					BLACK	GALV.

**CAST IRON REDUCERS**

Fig. 29



	3/4 x 1/2	50	50	44	21.09	POA
	1 x 3/4	50	50	64	★ 14.29	40.58
	1 x 1/2	50	50	58	★ 10.79	33.83
	1-1/4 x 1	50	50	105	★ 37.05	POA
	1-1/4 x 1/2	<b>NEW</b>	1	1	85	POA
	1-1/4 x 3/4	50	50	99	★ 31.68	68.25
	1-1/2 x 1/2	<b>NEW</b>	1	1	397	POA
	1-1/2 x 3/4	<b>NEW</b>	1	1	120	★ POA
	1-1/2 x 1	40	40	150	★ 52.44	102.59
	1-1/2 x 1-1/4	40	40	135	★ 52.44	102.59
	2 x 1-1/2	30	30	209	★ 68.59	POA
	2 x 1-1/4	30	30	204	★ 71.66	142.33
	2 x 1	30	30	172	★ 61.08	139.67
	2 x 3/4	30	30	172	★ 68.59	POA
	2 x 1/2	30	30	175	★ 76.15	POA
	2-1/2 x 2	18	18	300	97.48	POA
	2-1/2 x 1-1/2	18	18	325	108.41	POA
	3 x 2	12	12	435	119.47	POA
	3 x 1-1/2	12	12	458	165.46	POA
	3 x 2-1/2	<b>NEW</b>	1	1	440	POA
	4 x 2	<b>NEW</b>	1	1	605	POA
	4 x 2-1/2	<b>NEW</b>	1	1	780	POA
	4 x 3	<b>NEW</b>	1	1	700	POA
	6 x 4	<b>NEW</b>	1	1	1,335	POA

PIECES ORDERED	SIZE IN INCHES	PCS. PER BOX	PCS. PER MASTER CARTON	WGHT PER 100	PRICE PER PIECE	
					BLACK	GALV.

**CAST IRON PIPE CAPS**

Fig. 30



	2-1/2	6	6	225	64.62	111.38
	3	6	6	375	85.01	POA
	3-1/2	6	6			POA
	4	5	5	600	122.28	228.95
	5	6	6	1,014	186.19	359.35
	6	3	3	1,910	233.28	427.55
	8	<b>NEW</b>	1	1	2,825	POA

**CAST IRON COMPANION FLANGES CLASS 125**

**SCREWED FLANGES Fig. 20**



	1x4-1/4	10	10	166	★ 57.91	131.07
	1-1/4x4-5/8	10	10	205	★ 69.27	150.47
	1-1/2x5	10	10	261	★ 64.03	153.94
	2x6	6	6	444	63.90	135.38
	2-1/2x7	6	6	607	74.75	158.38
	3x7-1/2	5	5	764	96.28	192.46
	4x9	5	5	1,188	★ 129.75	262.13
	5x10	1	1	1,358	183.30	411.54
	6x11	3	3	1,745	207.40	439.86
	8x13-1/2	1	1	3,000	327.36	763.79
	10x16	1	1	4,200	580.17	POA

**CAST IRON ECCENTRIC REDUCERS Fig. 29E**

	3/4 x 1/2	50	50	45	44.39	POA
	1 x 3/4	1	1	60	47.92	POA
	1 x 1/2	1	1	63	46.59	POA
	1-1/4 x 1	1	1	89	71.39	POA
	1-1/4 x 3/4	50	50	109	69.38	POA
	1-1/4 x 1/2	1	1	85	76.57	POA
	1-1/2 x 1-1/4	1	1	125	96.78	POA
	1-1/2 x 1	1	1	115	101.22	POA
	1-1/2 x 3/4	1	1	110	101.22	POA
	1-1/2 x 1/2	<b>NEW</b>	1	1	117	96.41
	2 x 1/2	<b>NEW</b>	1	1	183	POA
	2 x 3/4	1	1	185	POA	POA
	2 x 1	30	30	178	132.12	POA
	2 x 1-1/4	30	30	189	125.82	POA
	2 x 1-1/2	<b>NEW</b>	30	30	198	128.35
	2-1/2 x 1	<b>NEW</b>	1	1	258	POA
	2-1/2 x 1-1/4	<b>NEW</b>	1	1	265	POA
	2-1/2 x 1-1/2	<b>NEW</b>	1	1	265	POA
	2-1/2 x 2	<b>NEW</b>	1	1	308	POA
	3 x 1	<b>NEW</b>	1	1	367	POA
	3 x 1-1/4	<b>NEW</b>	1	1	388	POA
	3 x 1-1/2	<b>NEW</b>	1	1	383	POA
	3 x 2	<b>NEW</b>	1	1	403	POA
	3 x 2-1/2	<b>NEW</b>	1	1	468	POA
	4 x 1-1/4	<b>NEW</b>	1	1	658	POA
	4 x 1-1/2	<b>NEW</b>	1	1	661	POA
	4 x 2	1	1	600	POA	POA

**CAST IRON REDUCING FLANGES CLASS 125 Fig. 71**



	3/4x5	10	10	300	167.37	272.74
	1x5	10	10	300	171.12	272.74
	1x6	6	6	450	163.10	260.49
	1-1/4x6	6	6	400	156.29	264.27
	1-1/2x6	6	6	425	133.77	264.27
	1-1/2x7	6	6	637	172.48	269.63
	2x7	6	6	615	125.14	291.21
	1x7-1/2	5	5	810	246.90	396.12
	1-1/4x7-1/2	5	5	800	246.90	381.81
	1-1/2x7-1/2	5	5	825	206.79	409.45
	2x7-1/2	5	5	800	166.86	392.35
	2-1/2x7-1/2	5	5	800	179.07	409.45
	3x8-1/2	5	5	1,000	POA	POA
	1-1/2x9	5	5	1,394	305.43	518.70
	2x9	1	1	1,403	226.79	549.70
	2-1/2x9	1	1	1,450	243.36	518.70
	3x9	1	1	1,313	226.79	549.70
	3-1/2x9	5	5	1,250	275.08	563.53
	2x10	1	1	1,850	417.97	669.04
	2-1/2x10	1	1	1,850	417.97	669.04
	3x10	1	1	1,750	419.23	655.43
	4x10	1	1	1,600	350.94	704.59
	1-1/2x11	1	1	2,410	537.61	892.81
	2x11	1	1	2,450	414.75	827.03
	2-1/2x11	1	1	2,225	492.79	887.37
	3x11	1	1	2,200	414.75	827.03
	4x11	1	1	2,012	342.06	818.93
	5x11	1	1	1,900	433.52	827.03

★ Preceding List Price Indicates Available In Master Quantity From Blossburg Factory ★ Preceding List Price Indicates Available In Box Quantity Only From Blossburg Factory

PIECES ORDERED		SIZE IN INCHES	PCS. PER BOX	PCS. PER MASTER CARTON	WGHT PER 100	PRICE PER PIECE	
BLACK	GALV.					BLACK	GALV.

PIECES ORDERED		SIZE IN INCHES	PCS. PER BOX	PCS. PER MASTER CARTON	WGHT PER 100	PRICE PER PIECE	
BLACK	GALV.					BLACK	GALV.

## CAST IRON REDUCING FLANGES CLASS 125

(continued) Fig. 71

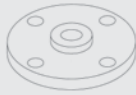

SIZE	PCS. PER BOX	PCS. PER MASTER CARTON	WGHT PER 100	PRICE PER PIECE BLACK	PRICE PER PIECE GALV.
2x13-1/2	1	1	3,080	760.19	1371.03
3x13-1/2	1	1	3,900	760.19	1362.68
4x13-1/2	1	1	4,056	585.46	1215.05
5x13-1/2	1	1	4,000	821.73	1241.06
6x13-1/2	1	1	3,800	530.74	1305.90

## CAST IRON 90° ELBOWS Class 250 Fig. 21H



SIZE	PCS. PER BOX	PCS. PER MASTER CARTON	WGHT PER 100	PRICE PER PIECE BLACK	PRICE PER PIECE GALV.
3/4	bulk	bulk	113	29.80	POA
1	bulk	bulk	179	36.04	POA
1-1/4	bulk	bulk	300	53.64	POA
1-1/2	bulk	bulk	405	66.56	POA
2	NEW bulk	bulk	676	82.13	POA

## CAST IRON BLIND FLANGES CLASS 125 Fig. 19



SIZE	PCS. PER BOX	PCS. PER MASTER CARTON	WGHT PER 100	PRICE PER PIECE BLACK	PRICE PER PIECE GALV.
1-1/4 x 4-5/8	10	10	200	POA	POA
1-1/2 x 5	10	10	275	103.38	175.79
1 x 4-1/4	10	10	150	92.16	157.86
2 x 6	6	6	450	116.78	182.90
2-1/2 x 7	6	6	675	128.36	213.31
3 x 7-1/2	5	5	850	153.85	266.23
4 x 9	1	1	1,456	197.06	372.60
5 x 10	1	1	2,000	320.17	608.32
6 x 11	1	1	2,475	348.30	645.80
8 x 13-1/2	1	1	4,000	546.47	853.76
10 x 16	1	1	6,044	808.43	1426.29

## CAST IRON FLOOR FLANGES CLASS 125 Fig. 15



SIZE	PCS. PER BOX	PCS. PER MASTER CARTON	WGHT PER 100	PRICE PER PIECE BLACK	PRICE PER PIECE GALV.
3/8	25	150	36	★ 18.93	POA
1/2	30	120	46	★ 19.47	48.63
3/4	30	120	48	★ 19.47	48.63
1	30	60	87	★ 24.44	44.39
1-1/4	30	60	80	★ 24.44	58.99
1-1/2	20	40	137	★ 31.46	75.60
2	15	30	215	★ 37.84	95.98
3	10	10	225	POA	POA
4	10	10	450	POA	POA

## CAST IRON FLANGE UNIONS CLASS 125 Fig. 14



SIZE	PCS. PER BOX	PCS. PER MASTER CARTON	WGHT PER 100	PRICE PER PIECE BLACK	PRICE PER PIECE GALV.
1/2	1	1	150	101.22	POA
3/4	1	1	250	133.51	POA
1	1	1	225	129.36	POA
1-1/4	1	1	329	153.00	POA
1-1/2	7	7	350	141.19	433.08
2	7	7	600	166.19	445.71
2-1/2	4	4	1,000	225.04	670.86
3-1/2	4	4	1,250	431.87	1221.18
3	4	4	1,115	254.56	889.39
4	3	3	1,450	346.15	1179.95
5	2	2	2,500	806.76	1398.36
6	2	2	2,850	757.30	POA

★ Preceding List Price Indicates Available In Master Quantity From Blossburg Factory ★ Preceding List Price Indicates Available In Box Quantity Only From Blossburg Factory

PIECES ORDERED		SIZE IN INCHES	PCS. PER BOX	PCS. PER MASTER CARTON	WGHT PER 100	PRICE PER PIECE	
BLACK	GALV.					BLACK	GALV.

**CAST IRON DRAINAGE SHORT TURN 90° ELBOWS Class 250**

Fig. 31



	1/2	<b>NEW</b>	1	1	67	POA	POA
	3/4	<b>NEW</b>	1	1	104	POA	POA
	1	<b>NEW</b>	1	1	160	POA	POA
	1-1/4	<b>NEW</b>	1	1	270	POA	POA
	1-1/2	<b>NEW</b>	1	1	355	POA	POA
	2	<b>NEW</b>	1	1	617	POA	POA
	2-1/2	<b>NEW</b>	1	1	938	POA	POA

**CAST IRON STRAIGHT TEES Class 250**

Fig. 24



	3/8	<b>NEW</b>	1	1	70	POA	POA
	1/2	<b>NEW</b>	1	1	101	POA	POA
	3/4	<b>NEW</b>	1	1	153	POA	POA
	1	<b>NEW</b>	1	1	243	POA	POA
	1-1/4	<b>NEW</b>	1	1	394	POA	POA
	1-1/2	<b>NEW</b>	1	1	531	POA	POA
	2	<b>NEW</b>	1	1	873	POA	POA
	2-1/2	<b>NEW</b>	1	1	1,423	POA	POA

**CAST IRON DRAINAGE SHORT TURN 90° ELBOWS**

Fig. 31



	1-1/2		25	25	193	45.33	67.17
	2		15	15	301	68.26	97.07
	3		6	6	750	256.40	383.7
	4		2	2	1,150	406.08	746.77
	1-1/2 x 1-1/4	<b>NEW</b>	1	1	169	POA	POA
	2x1-1/2		20	20	275	★ 92.74	POA

**LONG TURN 90° ELBOWS**

Fig. 33



	1-1/2		15	15	216	63.42	76.38
	2		10	10	370	94.44	131.12
	3		5	5	838	★ 344.46	

**EXTRA LONG TURN 90° ELBOWS**

Fig. 78



	1-1/2		15	15	324	81.91	POA
	2		10	10	415	141.64	186.31

**SHORT TURN 60° ELBOWS**

Fig. 37



	1-1/2		25	25	182	82.05	POA
	2		15	15	270	94.17	POA

**SHORT TURN 45° ELBOWS**

Fig. 32



	1-1/4		25	25	135	42.51	65.02
	1-1/2		25	25	168	44.30	66.4
	2		15	15	257	63.97	95.02
	3		6	6	694	250.54	330.67
	4		2	2	1,100	391.61	540.32

**LONG TURN 45° ELBOWS**

Fig. 34



	1-1/2		15	15	210	62.26	POA
	2		10	10	310	★ 106.16	133.33

**SHORT TURN 22-1/2° ELBOWS**

Fig. 74



	1-1/2		25	25	149	55.85	72.01
	2		15	15	260	74.40	107.70

**SHORT TURN 11-1/4° ELLS**

Fig. 75



	1-1/2		25	25	165	59.44	POA
--	-------	--	----	----	-----	-------	-----

**STREET 90° ELBOWS**

Fig. 35



	1-1/2		25	25	180	64.62	85.08
	2		15	15	260	85.56	133.32

**STREET 45° ELBOWS**

Fig. 36



	1-1/2		25	25	155	60.35	88.04
	2		15	15	240	97.69	135.46

PIECES ORDERED		SIZE IN INCHES	PCS. PER BOX	PCS. PER MASTER CARTON	WGHT PER 100	PRICE PER PIECE	
BLACK	GALV.					BLACK	GALV.

## DRAINAGE TEES

Fig. 38



	1-1/2	15	15	270	74.48	101	
	2	10	10	425	123.15	169.02	
	2x1-1/2	10	10	350	★ 140.22	190.72	

## SHORT TURN 90° TYS

Fig. 39



	1-1/2	15	15	320	73.14	102.22	
	2	10	10	488	120.55	167.05	
	4	1	1	2,000	657.72	806.36	
	2x1-1/2	10	10	370	123.95	191.76	
	2x1-1/2x1-1/2	10	10	350	123.95	POA	
	2x1-1/2x2	10	10	475	123.95	POA	

## LONG TURN 90° TYS

Fig. 40



	1-1/2	10	10	440	★ 122.23	169.84	
	2	6	6	700	190.59	307.99	
	2 x 1-1/2	8	8	500	200.04	308.01	
	2 x 1-1/2 x 1-1/2	8	8	-		328.36	

PIECES ORDERED		SIZE IN INCHES	PCS. PER BOX	PCS. PER MASTER CARTON	WGHT PER 100	PRICE PER PIECE	
BLACK	GALV.					BLACK	GALV.

## SHORT TURN 45° Y BRANCHES

Fig. 41



	1-1/2	15	15	360	89.58	113.39	
	2	10	10	509	167.07	227.3	
	3	<b>NEW</b>	1	1,345		POA	
	4		1	2,400	859.78	1236.59	
	2 x 1-1/2 x 1-1/2	10	10	452	187.76	POA	
	2 x 2 x 1-1/2	10	10	450	165.19	POA	
	4 x 3	1	1	2,000	897.83	1263.24	

## DOUBLE 90° Y BRANCHES

Fig. 42



	1-1/2	10	10	376	217.18	175.09	
	2	8	8	650	179.49	253.37	
	2 x 1-1/2	8	8	513	184.17	253.37	

## P TRAP WITH CLEANOUT

Fig. 45



	1-1/2	10	10	380	100.26	138.14	
	2	8	8	700	160.52	241.77	

## P TRAP WITHOUT DRAIN

Fig. 46



	1-1/2	10	10	380	136.93	180.20	
	2	8	8	647	219.19	315.44	

PIECES ORDERED	SIZE IN INCHES	PCS. PER BOX	PCS. PER MASTER CARTON	WGHT PER 100	PRICE PER PIECE	
					BLACK	GALV.
<b>FLANGED 90° ELLS</b>						
	2	1	1	1,300	396.87	823.56
	2-1/2	1	1	1,900	429.28	1126.58
	3	1	1	2,400	358.30	1110.56
	4	1	1	4,000	443.12	1012.47
	5	1	1	5,700	1049.47	2133.97
	6	1	1	7,000	693.79	1630.09
	8	1	1	11,600	1198.00	2539.08
	10	1	1	17,700	2625.62	4698.54
	12	1	1	24,800	5285.55	7840.27
	3X2-1/2	1	1	2,300	1327.46	1630.45
	3X2	1	1	2,100	1216.87	1440.20
	4X3	1	1	3,500	983.05	1530.88
	4X2-1/2	1	1	3,500	1502.46	1778.27
	4X2	1	1	3,200	1502.46	1778.27
	6X5	1	1	6,600	2071.07	2451.54
	6X4	1	1	6,700	1219.08	2469.91
	6X3	1	1	5,900	2165.22	2924.26
	8X6	1	1	9,200	1778.66	3507.49
	8X5	1	1	9,200	3168.53	4279.33
	8X4	1	1	8,900	2398.51	4161.32
	10X8	1	1	16,000	3386.66	6496.92
	10X6	1	1	15,500	4947.06	6681.07
	12X10	1	1	23,700	6489.89	11266.45
	12X8	1	1	23,400	8576.16	11582.25



PIECES ORDERED	SIZE IN INCHES	PCS. PER BOX	PCS. PER MASTER CARTON	WGHT PER 100	PRICE PER PIECE	
					BLACK	GALV.
<b>FLANGED 45° ELLS</b>						
	2	1	1	1,100	575.05	1061.74
	2-1/2	1	1	1,900	613.34	1047.82
	3	1	1	2,100	596.44	1178.22
	4	1	1	3,700	671.32	1461.82
	5	1	1	3,700	1608.63	2641.97
	6	1	1	6,000	1097.53	2039.16
	8	1	1	9,600	1604.94	3058.42
	10	1	1	14,700	3391.30	5853.49
	12	1	1	21,200	5181.90	8940.64



PIECES ORDERED	SIZE IN INCHES	PCS. PER BOX	PCS. PER MASTER CARTON	WGHT PER 100	PRICE PER PIECE	
					BLACK	GALV.
<b>FLANGED 22-1/2° ELLS</b>						
	4	1	1	3,530	753.51	1446.17
	6	1	1	5,730	1087.97	2088.89
	8	1	1	9,230	1632.26	3133.61
	10	1	1			5708.11
	12	1	1	21,610	5126.84	8478.1



PIECES ORDERED	SIZE IN INCHES	PCS. PER BOX	PCS. PER MASTER CARTON	WGHT PER 100	PRICE PER PIECE	
					BLACK	GALV.
<b>FLANGED LONG RADIUS 90° ELLS</b>						
	2	1	1	1,500	1068.72	1380.57
	2-1/2	1	1	2,200	POA	1957.69
	3	1	1	2,800	1154.48	POA
	4	1	1	4,700	1058.77	2771.02
	6	1	1	9,200	1531.46	2944.22
	8	1	1	13,400	2943.65	5121.96
	10	1	1	21,600	4582.42	7955.88
	12	1	1	35,600	9442.26	15666.77



PIECES ORDERED	SIZE IN INCHES	PCS. PER BOX	PCS. PER MASTER CARTON	WGHT PER 100	PRICE PER PIECE	
					BLACK	GALV.
<b>FLANGED LONG RADIUS 90° REDUCING ELLS</b>						
	4X3	1	1	4,200	2520.16	2944.39
	6X4	1	1	8,100	3289.40	4442.39
	8X6	1	1	13,000	6080.21	7884.69



PIECES ORDERED	SIZE IN INCHES	PCS. PER BOX	PCS. PER MASTER CARTON	WGHT PER 100	PRICE PER PIECE	
					BLACK	GALV.
<b>FLANGED CONCENTRIC REDUCERS</b>						
	2-1/2X2	1	1	1,400	1001.62	1588.09
	3X2-1/2	1	1	2,000	795.16	1303.94
	3X2	1	1	1,700	795.16	1358.72
	4X3	1	1	2,900	893.42	1585.94
	4X2-1/2	1	1	2,700	961.04	1882.81
	4X2	1	1	2,400	1062.16	1882.81
	5X3	1	1	4,100	1571.41	2769.71
	5X4	1	1	4,000	1381.48	2457.28
	6X5	1	1	5,200	1314.32	2665.27
	6X4	1	1	5,000	1196.49	2310.71
	6X3	1	1	4,200	1377.38	2716.34
	6X2-1/2	1	1	3,900	1817.14	3138.12
	6X2	1	1	3,900	2402.62	3990.44
	8X6	1	1	8,000	1505.83	2675.28
	8X5	1	1	7,500	2726.68	3737.99
	8X4	1	1	7,400	1734.66	3494.10
	10X8	1	1	12,000	3105.49	6123.09
	10X6	1	1	10,800	3382.44	6803.49
	12X10	1	1	19,500	5356.48	10281.07
	12X8	1	1	15,800	5920.40	10281.07
	12X6	1	1	15,300	6190.16	10748.60



PIECES ORDERED	SIZE IN INCHES	PCS. PER BOX	PCS. PER MASTER CARTON	WGHT PER 100	PRICE PER PIECE	
					BLACK	GALV.
<b>FLANGED 90° BASE ELLS</b>						
	3	1	1	3,200	POA	2325.30
	4	1	1	5,200	1721.84	2325.30
	6	1	1	8,800	2933.60	3961.97
	8	1	1	15,300	3887.77	5248.29
	10	1	1	22,700	6527.64	8432.51
	12	1	1	34,000	POA	12140.58



PIECES ORDERED		SIZE IN INCHES	PCS. PER BOX	PCS. PER MASTER CARTON	WGHT PER 100	PRICE PER PIECE	
BLACK	GALV.					BLACK	GALV.

## FLANGED ECCENTRIC REDUCERS



	3X2	1	1	1,700	1199.48	1619.92
	3x2-1/2	1	1	1,600	1216.87	1620.92
	4X3	1	1	2,800	1450.09	2164.51
	4X2	1	1	2,500	1675.62	2164.51
	6X5	1	1	5,500	1369.68	2701.97
	6X4	1	1	4,900	1369.68	2573.65
	6X3	1	1	4,400	2286.25	3087.46
	8X6	1	1	8,400	1735.01	3257.33
	8X5	1	1	7,500	2250.58	3907.77
	8X4	1	1	7,300	2352.84	3907.77
	10X8	1	1	12,500	4419.51	6696.40
	10X6	1	1	11,200	5183.69	7000.71
	12X10	1	1	18,500	5990.64	9162.58
	12X8	1	1	16,700	6204.60	10773.58

## STANDARD FLANGED TEES



	2	1	1	1,700	434.54	777.04
	2-1/2	1	1	2,700	632.90	1049.17
	3	1	1	3,700	443.56	1053.42
	4	1	1	6,400	674.71	1667.70
	5	1	1	8,300	1807.44	2476.67
	6	1	1	10,500	979.12	2293.01
	8	1	1	16,300	1672.78	3615.12
	10	1	1	26,000	4501.01	6861.50
	12	1	1	40,200	7070.62	10481.81

## REDUCING FLANGED TEES



	3X3X2-1/2	1	1	3,800	1316.73	1795.94
	3 X3X2	1	1	3,400	1030.72	1789.98
	4X4X6	1	1	8,300	2681.81	3522.05
	4 X4X3	1	1	5,900	1388.75	2409.51
	4 X3X4	1	1	5,500	POA	4060.38
	4 X4X2-1/2	1	1	5,500	1516.63	2520.78
	4X4X2	1	1	5,400	1388.75	2310.01
	6X4X6	1	1	9,500	1540.37	3038.77
	6X4X4	1	1	9,000	1702.56	3020.30
	6X6X8	1	1	13,800	3316.33	5759.40
	6X6X4	1	1	9,600	1336.93	2600.81
	6X6X3	1	1	9,700	1944.89	3376.32
	6X6X2-1/2	1	1	8,800	2602.22	3364.15
	6X6X2	1	1	8,700	2732.36	3528.49
	8X6X8	1	1	14,900	3316.33	5958.38
	8X6X6	1	1	13,900	2510.06	4947.99
	8X6X4	1	1	12,700	4255.19	5388.11
	8X8X6	1	1	15,500	2088.51	4623.51
	8X8X4	1	1	14,400	2509.66	4712.98
	8X8X10	1	1	23,400	POA	9065.36

PIECES ORDERED		SIZE IN INCHES	PCS. PER BOX	PCS. PER MASTER CARTON	WGHT PER 100	PRICE PER PIECE	
BLACK	GALV.					BLACK	GALV.

## REDUCING FLANGED TEES (continued)



	10X8X8	1	1	23,600	5276.80	8966.54
	12X12X4	1	1	34,100	POA	13597.24
	10X10X12	1	1	34,200	8186.26	14376.24
	10X10X8	1	1	24,900	4774.30	8966.54
	10X10X6	1	1	22,900	5552.43	8973.13
	10X10X4	1	1	22,000	5422.36	9005.57
	12X12X10	1	1	36,700	8263.73	13597.24
	12X12X8	1	1	36,700	8383.09	13597.24
	12X12X6	1	1	35,700	7085.06	13597.24

## FLANGED BASE TEES



	3	1	1	4,700	POA	1635.31
	4	1	1	7,200	POA	2239.94
	6	1	1	12,200	POA	3897.43
	8	1	1	21,100	POA	6477.85
	10	1	1	30,000	POA	10438.43
	12	1	1	43,000	POA	15067.07

## FLANGED CROSSES



	2-1/2	1	1	4,100	1261.11	2271.47
	3	1	1	5,000	1324.21	2195.65
	4	1	1	8,200	1729.70	3002.26
	6	1	1	13,400	3622.50	4892.57
	8	1	1	21,300	5834.24	7535.76
	10	1	1	33,000	6921.04	12235.43
	12	1	1	46,000	10558.05	18543.76

## FLANGED REDUCING CROSSES



	6X4	1	1	11,900	2447.56	3995.71
	8X6	1	1	18,400	3784.61	6176.73

## FLANGED LATERAL



	2-1/2	1	1	3,400	1774.11	2610.88
	3	1	1	4,500	1897.77	2523.56
	4	1	1	7,700	2477.36	3345.84
	6	1	1	13,000	3768.91	5710.73
	8	1	1	21,300	6175.61	8465.46
	10	1	1	33,500	7972.84	13995.60
	12	1	1	51,500	POA	21447.12

PIECES ORDERED		SIZE IN INCHES	PCS. PER BOX	PCS. PER MASTER CARTON	WGHT PER 100	PRICE PER PIECE	
BLACK	GALV.					BLACK	GALV.

## WARDLOX TEES SLIP X SLIP X SLIP

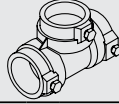

	1X1X1	12	12	289	74.53	POA
	1-1/4X1-1/4X1-1/4	12	12	366	74.53	POA
	1-1/2X1-1/2X1-1/2	12	12	388	75.72	98.65
	2X2X2	4	4	641	104.00	133.14

## WARDLOX REDUCING OUTLET TEES SLIP X SLIP X SLIP

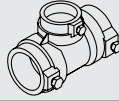

	2X2X1	8	8	467	91.11	112.88
	2X2X1-1/4	5	5	529	91.11	112.88
	2X2X1-1/2	5	5	593	91.11	112.88

## WARDLOX BULLHEAD TEES SLIP X SLIP X SLIP

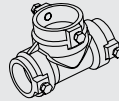

	1-1/2X1-1/2X2	5	5	535	91.11	112.88
--	---------------	---	---	-----	-------	--------

## WARDLOX REDUCING OUTLET TEES SLIP X SLIP X THREAD

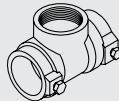

	1X1X1/2	20	20	200	51.09	POA
	1X1X3/4	20	20	196	51.09	66.79
	1X1X1	20	20	174	51.09	66.79
	1-1/4X1-1/4X1/2	15	15	249	51.09	POA
	1-1/4X1-1/4X3/4	15	15	256	51.09	POA
	1-1/4X1-1/4X1	15	15	240	51.09	66.79
	1-1/2X1-1/2X1/2	15	15	298	54.11	POA
	1-1/2X1-1/2X3/4	10	10	292	54.11	71.36
	1-1/2X1-1/2X1	10	10	285	54.11	POA
	2X2X1/2	9	9	402	66.25	POA
	2X2X3/4	9	9	393	66.25	POA
	2X2X1	9	9	366	66.25	87.62

## WARDLOX REDUCING RUN AND OUTLET TEES TEES SLIP X SLIP X THREAD

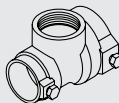

	1-1/4X1X1/2	15	15	233	54.64	POA
	1-1/4X1X1	15	15	236	54.64	POA
	1-1/2X1-1/4X1/2	10	10	276	57.97	76
	1-1/2X1-1/4X3/4	10	10	288	57.97	76
	1-1/2X1-1/4X1	10	10	272	57.97	POA
	2X1-1/2X1/2	9	9	381	70.12	POA
	2X1-1/2X3/4	9	9	372	70.12	POA
	2X1-1/2X1	9	9	360	70.12	92.17

PIECES ORDERED		SIZE IN INCHES	PCS. PER BOX	PCS. PER MASTER CARTON	WGHT PER 100	PRICE PER PIECE	
BLACK	GALV.					BLACK	GALV.

## WARDLOX 90° ELBOWS SLIP X SLIP

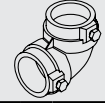

	1	20	20	206	54.54	POA
	1-1/4	15	15	253	63.77	POA
	1-1/2	10	10	290	69.90	90.23
	2	6	6	415	82.60	107.18

## WARDLOX ADAPTER ELBOWS SLIP X THREAD

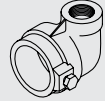

	1X1/2	25	25	150	65.08	85.22
	1X3/4	25	25	138	65.08	85.22
	1X1	25	25	160	65.08	85.22
	1-1/4X1/2	15	15	207	67.33	90.70
	1-1/4X3/4	15	15	199	67.33	POA
	1-1/4X1	15	15	188	67.33	POA
	1-1/2X1/2	10	10	248	69.27	95.81
	1-1/2X3/4	10	10	236	69.27	95.81
	1-1/2X1	10	10	238	69.27	95.81
	2X1/2	9	9	302	71.42	99.90
	2X3/4	9	9	323	71.42	POA
	2X1	9	9	288	71.42	99.90

## WARDLOX COUPLINGS SLIP X SLIP

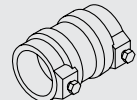

	1X1	25	25	154	48.83	63.59
	1-1/4X1-1/4	15	15	227	48.83	POA
	1-1/2X1-1/2	15	15	261	61.41	POA
	2X2	10	10	360	61.41	82.94

## WARDLOX GASKETS SLIP X SLIP

	1	25	25	14.01
	1-1/4	25	25	16.39
	1-1/2	25	25	19.46
	2	1	1	20.58

## WARDLOX BOLTS / SOCKETS

	3/8 Square Head	4	5.80
--	-----------------	---	------

PIECES ORDERED		SIZE IN INCHES	PCS. PER BOX	PCS. PER MASTER CARTON	WGHT PER 100	PRICE PER PIECE	
BLACK	GALV.					BLACK	GALV.

PIECES ORDERED		SIZE IN INCHES	PCS. PER BOX	PCS. PER MASTER CARTON	WGHT PER 100	PRICE PER PIECE	
BLACK	GALV.					BLACK	GALV.

**TEELOX MECHANICAL BRANCH CONNECTOR**

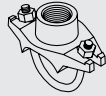

	1-1/4X1/2	25	25	98	11.89	22.66
	1-1/4X3/4	25	25	99	11.89	22.66
	1-1/4X1	25	25	108	14.84	23.90
	1-1/2X1/2	25	25	98	11.89	23.90
	1-1/2X3/4	25	25	99	11.89	23.90
	1-1/2X1	25	25	108	14.84	23.90
	2X1/2	25	25	96	11.89	23.90
	2X3/4	25	25	85	11.89	23.90
	2X1	25	25	99	14.84	24.94
	2-1/2X1/2	25	25	121	11.89	27.87
	2-1/2X3/4	25	25	120	11.89	27.87
	2-1/2X1	25	25	111	14.84	45.40

**TEELOX MECHANICAL BRANCH CONNECTOR**

SIZE	A	B	C
1-1/4X1/2	2	1-1/2	1-3/16
1-1/4X3/4	2-1/16	1-1/2	1-3/16
1-1/4X1	2-1/8	1-1/2	1-3/16
1-1/2X1/2	2	1-1/2	1-3/16
1-1/2X3/4	2-1/16	1-1/2	1-3/16
1-1/2X1	2-1/8	1-1/2	1-3/16
2X1/2	2-5/16	1-13/16	1-3/16
2X3/4	2-3/8	1-13/16	1-3/16
2X1	2-7/16	1-13/16	1-3/16
2-1/2X1/2	2-9/16	2-1/16	1-3/16
2-1/2X3/4	2-11/16	2-1/8	1-3/16
2-1/2X1	2-3/4	2-1/8	1-3/16

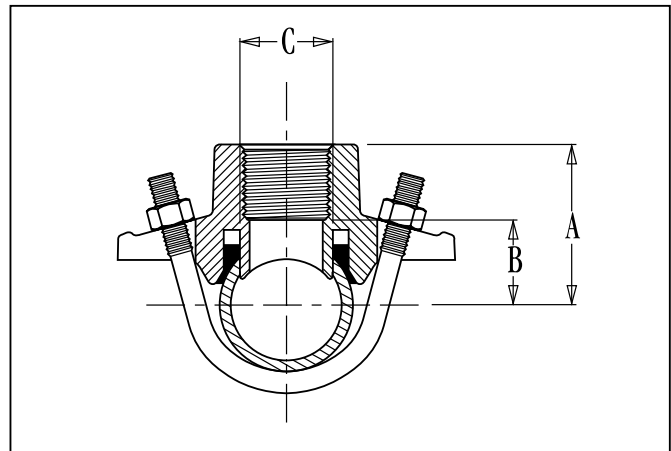

PIECES ORDERED		SIZE IN INCHES	PCS. PER BOX	PCS. PER MASTER CARTON	WGHT PER 100	PRICE PER PIECE	
BLACK	GALV.					BLACK	GALV.

PIECES ORDERED		SIZE IN INCHES	PCS. PER BOX	PCS. PER MASTER CARTON	WGHT PER 100	PRICE PER PIECE	
BLACK	GALV.					BLACK	GALV.

## STEEL SQUARE HEAD PLUGS



	1/8"	100	600	2	★ 0.55	★ 0.56
	1/4"	100	600	4	★ 0.72	★ 0.78
	3/8"	75	450	6	★ 0.99	★ 1.03
	1/2"	50	300	12	★ 1.66	★ 1.87
	3/4"	50	200	18	★ 2.35	★ 2.69

## STEEL HEX SOCKET PLUGS

	1/8"	100	600	1	★ 0.55	★ 0.53
	1/4"	100	600	2	★ 0.72	★ POA
	3/8"	100	600	3	★ 0.99	★ POA
	1/2"	100	600	7	★ 1.66	★ POA

## STEEL HEXAGON BUSHINGS



	1/4" X 1/8"	25	150	2	★ 1.53	★ 1.58
	3/8" X 1/8"	25	150	5	★ 1.80	★ 1.95
	3/8" X 1/4"	25	150	4	★ 1.80	★ 1.95
	1/2" X 1/8"	25	150	8	★ 3.23	★ 3.13
	1/2" x 1/4"	25	150	7	★ 2.81	★ 3.13
	1/2" x 3/8"	25	150	6	★ 2.81	★ 3.13
	3/4" x 1/8"	50	200	20	★ 4.37	★ 4.91
	3/4" x 1/4"	50	200	16	★ 4.37	★ 4.91
	3/4" x 3/8"	50	200	14	★ 4.37	★ 4.91
	3/4" x 1/2"	50	200	10	★ 4.37	★ 4.91
	1" x 1/8"	25	100	35	★ 4.76	★ POA
	1" x 1/4"	25	100	31	★ 4.76	★ 5.48
	1" x 3/8"	25	100	30	★ 4.76	★ 5.48
	1" x 1/2"	25	100	25	★ 4.76	★ 5.48
	1" x 3/4"	25	100	15	★ 4.76	★ 5.48

## STEEL SQUARE HEAD COUNTER SUNK PLUGS



	1/4"	100	600	2	★ 0.72	★ 0.78
	3/8"	75	450	2	0.99	1.03

## STEEL HEX CAPS

	1/8"	50	300	3	★ 1.36	★ 1.42
	1/4"	40	240	7	★ 1.76	★ 1.89
	3/8"	40	240	9	★ 2.61	★ 2.86
	1/2"	50	200	12	★ 4.10	★ 4.10
	3/4"	25	150	16	★ 8.66	★ 9.58

## STEEL FLUSH BUSHINGS



	1/4" X 1/8"	25	150	1	1.61	1.69
	3/8" X 1/4"	25	150	1	1.87	POA
	1/2" x 1/4"	25	150	3	4.28	5.13
	1/2" x 3/8"	25	150	2	4.28	5.13
	3/4" x 1/4"	25	150	8	5.99	7.19
	3/4" x 3/8"	25	150	7	5.99	7.19
	3/4" x 1/2"	25	150	5	★ 5.99	★ 7.19

## STEEL REDUCER COUPLINGS

Fig. 29



	1/4" x 1/8"	25	150	9	★ 7.67	★ POA
--	-------------	----	-----	---	--------	-------

# QUALITY PIPE FITTINGS SINCE 1924

Products from Ward Manufacturing

Class 150 Malleable Fittings  
Class 300 Malleable Fittings  
Class 125 Cast Iron Fittings  
Cast Iron Flanged Fittings  
Drainage Fittings  
Class 150 Unions  
Class 250 Unions  
Class 300 Unions  
Di-Electric Unions  
Brass to Brass Seat Unions  
Top Beam and C-Clamps  
TEELOX™ WARDLOX™ Fittings for Plain End Pipe  
WARDFLEX™ Corrugated Stainless Steel Tubing System  
for Natural Gas and LP Gas  
Gray, Malleable and Ductile Iron Custom Castings

**WARD MANUFACTURING  
PRODUCTS ARE  
DISTRIBUTED BY:**

Visit our website @ [www.wardmfg.com](http://www.wardmfg.com)



**WARD MANUFACTURING**

**NATIONAL SALES MANAGER  
PIPING PRODUCTS**

Kieran Young  
203 Brion Lane  
Chalfont, PA 18914  
Phone: 215-997-2850  
Fax: 215-997-6751  
Cell: 267-640-5577  
Email: [kieran.young@wardmfg.com](mailto:kieran.young@wardmfg.com)

**SALES OFFICE**

WARD COUPLUX  
A Division of Ward Manufacturing, LLC  
6355 Shawson Dr. Unit #2  
Mississauga, Ont., Canada L5T 1S7  
Phone: 905-564-6488  
Fax: 905-564-6475

